

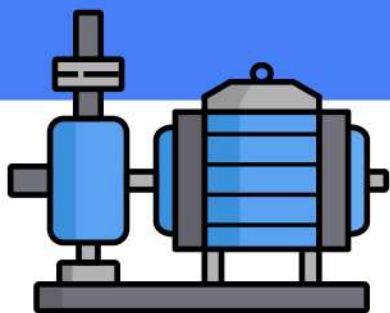

Pompes



En savoir plus

flocea.com

cliquez ici !

Nous sommes en 



09 70 44 02 48

DES SOLUTIONS FIABLES POUR LA MAISON,
L'INDUSTRIE ET L'AGRICULTURE

www.flocea.com



CONTENTS

www.submersiblepumpcn.com

FLOQB SERIES PERIPHERAL PUMPS » P02 	FLOSCM SERIES CENTRIFUGAL PUMPS » P11 	FLOJTM/L/P SERIES SELF-PRIMING JET PUMPS » P20 	FLO V SERIES SEWAGE SUBMERSIBLE PUMPS » P31 	FLO GP/AUGP SERIES GARDEN JET PUMP » P40 	FLO 4SDM 10 SERIES DEEP WELL SUBMERSIBLE PUMP » P55 
FLO PKM SERIES PERIPHERAL PUMPS » P03 	FLO CB SERIES CENTRIFUGAL PUMPS » P12 	FLO JSW SERIES SELF-PRIMING JET PUMPS » P21 	FLO V-D SERIES LIGHTING SEWAGE SUBMERSIBLE PUMPS » P32 	FLO 3SDM SERIES DEEP WELL SUBMERSIBLE PUMP » P41 	FLO 4SP SERIES DEEP WELL SUBMERSIBLE PUMP » P57 
FLO IDB/PM SERIES PERIPHERAL PUMPS » P04 	FLO BMC SERIES MULTI-STAGE CENTRIFUGAL PUMPS » P13 	FLO SWP SERIES SELF-PRIMING JET PUMPS » P22 	FLO SEWAGE SUBMERSIBLE PUMPS » P33 	FLO 3.5SDM SERIES DEEP WELL SUBMERSIBLE PUMP » P43 	FLO 4SKM SERIES DEEP WELL SUBMERSIBLE PUMP » P59 
FLO IZDB SERIES SELF-PRIMING PERIPHERAL PUMPS » P05 	FLO AUTO SERIES WATER PUMPS » P14 	FLO JS SERIES SELF-PRIMING JET PUMPS » P23 	FLO WQD SERIES SEWAGE PUMPS » P34 	FLO 4SDM 2 SERIES DEEP WELL SUBMERSIBLE PUMP » P45 	FLO3Q6/4Q6 SERIES DEEP WELL SUBMERSIBLE PUMP » P61 
FLO WZB SERIES SELF-PRIMING PERIPHERAL PUMPS » P06 	FLO CPS SERIES CENTRIFUGAL PUMPS » P15 	FLO DP SERIES SELF-PRIMING JET PUMPS » P24 	FLO WQD SERIES SEWAGE PUMPS » P35 	FLO 4SDM 3 SERIES DEEP WELL SUBMERSIBLE PUMP » P47 	CIRCULATION PUMP » P63 
FLO AWZB SERIES SELF-PRIMING PERIPHERAL PUMPS » P07 	FLO DK SERIES CENTRIFUGAL PUMPS » P16 	FLO QDX SERIES SUBMERSIBLE PUMPS » P25 	WQ SERIES SEWAGE PUMPS » P36 	4SDM 4 SERIES DEEP WELL SUBMERSIBLE PUMP » P49 	VMP MAKING VIBRATION PUMPS » P69 
FLO PW SERIES SELF-PRIMING PERIPHERAL PUMPS » P08 	FLO HFM SERIES CENTRIFUGAL PUMPS » P17 	FLO QDX-T SERIES SUBMERSIBLE PUMPS » P27 	GSP SERIES GARDEN SUBMERSIBLE PUMPS » P38 	4SDM 6 SERIES DEEP WELL SUBMERSIBLE PUMP » P51 	ACCESSORIES » P70 
FLO CPM SERIES CENTRIFUGAL PUMPS » P10 	FLO JETS SERIES SELF-PRIMING JET PUMPS » P19 	FLO SPA-A SERIES SUBMERSIBLE PUMPS » P29 	GSP SERIES GARDEN SUBMERSIBLE PUMPS » P39 	4SDM 8 SERIES DEEP WELL SUBMERSIBLE PUMP » P53 	

FLOQB SERIES PERIPHERAL PUMPS

OPERATING LIMITS

- Max. suction: 8 m
- Max. medium temperature: +40°C
- Max. ambient temperature: +40°C
- Max. pressure: 6 bar

MATERIAL

- Pump body: Cast iron, with brass/ AISI304 SS insert if request
- Pump support: Cast iron, with brass/ AISI304 SS insert if request
- Motor housing: Aluminum
- Impeller: Brass
- Motor wire: copper
- Mechanical seal: Graphite&Ceramic
- Shaft: AISI304 stainless steel

MOTOR INFORMATION

- Two-pole induction motor
- Single phase/three phase, 50/60Hz (on demand)
- Thermal protector for single phase
- Insulation class: B
- Protection class: IP 44

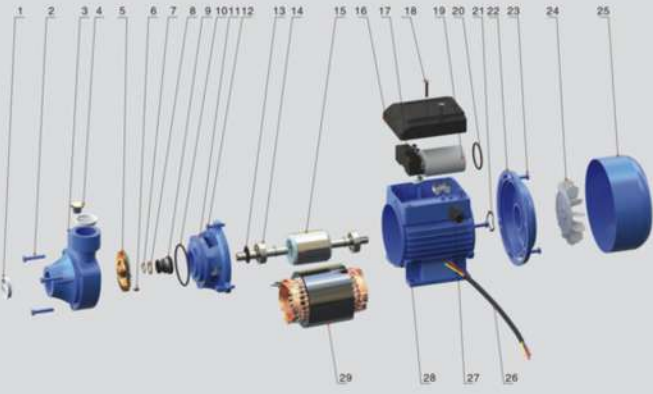

TECHNICAL DATA

No.	Description	No.	Description	No.	Description
1	Dustproof cover	11	Pump support	21	Spring Washer
2	Bolt	12	Bolt	22	Motor cover
3	Pump body	13	Water proof gland	23	Bolt
4	Filling plug	14	Bearing	24	Fan
5	Impeller	15	Rotor	25	Fan cover
6	Key	16	Terminal box	26	Cable
7	Circlip	17	Terminal board	27	Cable holder
8	Spring Washer	18	Bolt	28	Motor housing
9	Mechanical seal	19	Capacitor	29	Stator
10	O Ring	20	O Ring		

PERFORMANCE CHART AT $n = 2850 \text{ min}^{-1}$

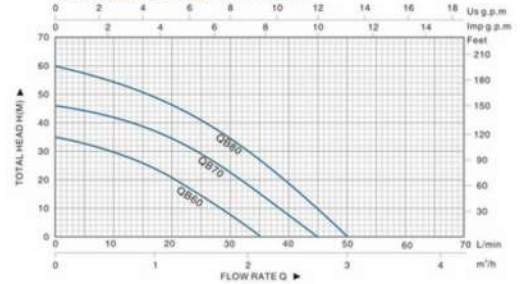

TECHNICAL DATA

Model	Power		Q. Max (L/min)	H. Max (m)	S. Max (m)	Inlet/Outlet (inch)	G.W. (kg)	Packing dimension		20GP (pcs)
	(Kw)	(HP)						(mm)	(pcs/ctn)	
FLOQB60	0.37	0.5	35	35	8	1"x1"	5.5	430 x 285 x 345	6	4050
FLOQB70	0.55	0.75	45	48	8	1"x1"	9	370 x 340 x 220	2	2100
FLOQB80	0.75	1	50	60	8	1"x1"	10	370 x 340 x 220	2	2100

FLOQB SERIES PERIPHERAL PUMPS

OPERATING LIMITS

- Max. suction: 8 m
- Max. medium temperature: +40°C
- Max. ambient temperature: +40°C
- Max. pressure: 6 bar

MATERIAL

- Pump body: Cast iron, with brass/ AISI304 SS insert if request
- Pump support: Cast iron, with brass/ AISI304 SS insert if request
- Motor housing: Aluminum
- Impeller: Brass
- Motor wire: copper
- Mechanical seal: Graphite&Ceramic
- Shaft: AISI304 stainless steel

MOTOR INFORMATION

- Two-pole induction motor
- Single phase/three phase, 50/60Hz (on demand)
- Thermal protector for single phase
- Insulation class: B
- Protection class: IP 44



TECHNICAL DATA

No.	Description	No.	Description	No.	Description
1	Dustproof cover	11	Pump support	21	Spring Washer
2	Bolt	12	Bolt	22	Motor cover
3	Pump body	13	Water proof gland	23	Bolt
4	Filling plug	14	Bearing	24	Fan
5	Impeller	15	Rotor	25	Fan cover
6	Key	16	Terminal box	26	Cable
7	Circlip	17	Terminal board	27	Cable holder
8	Spring Washer	18	Bolt	28	Motor housing
9	Mechanical seal	19	Capacitor	29	Stator
10	O Ring	20	O Ring		

PERFORMANCE CHART AT $n = 2850 \text{ min}^{-1}$

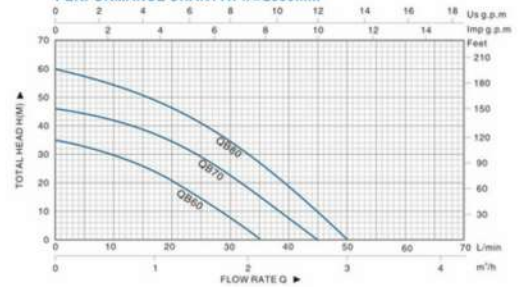

TECHNICAL DATA

Model	Power		Q. Max (L/min)	H. Max (m)	S. Max (m)	Inlet/Outlet (inch)	G.W. (kg)	Packing dimension		20GP (pcs)
	(Kw)	(HP)						(mm)	(pcs/ctn)	
FLOQB60	0.37	0.5	35	35	8	1"x1"	5.5	430 x 285 x 345	6	4050
FLOQB70	0.55	0.75	45	48	8	1"x1"	9	370 x 340 x 220	2	2100
FLOQB80	0.75	1	50	60	8	1"x1"	10	370 x 340 x 220	2	2100

FLO PKM SERIES

PERIPHERAL PUMPS

OPERATING LIMITS

- Max. suction: 8 m
- Max. medium temperature: +60°C
- Max. ambient temperature: +40°C
- Max. pressure: 6 bar

MATERIAL

- Pump body: Cast iron, with brass/ AISI304 SS insert if request
- Pump support: Cast iron, with brass/ AISI304 SS insert if request
- Motor housing: Aluminum
- Impeller: Brass
- Motor wire: copper
- Mechanical seal: Graphite&Ceramic
- Shaft: AISI304/stainless steel

MOTOR INFORMATION

- Two-pole induction motor
- Single phase/three phase, 50/60Hz (on demand)
- Thermal protector for single phase
- Insulation class: B
- Protection class: IP 44



PKM

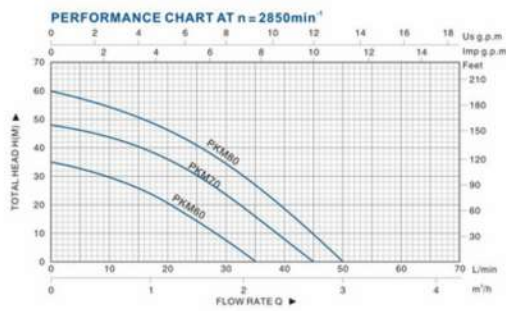

TECHNICAL DATA

Model	Power		Q. Max (L/min)	H. Max (m)	S. Max (m)	Inlet/Outlet (inch)	G.W. (kg)	Packing dimension		20GP (pcs)
	(Kw)	(HP)						(mm)	(pcs/ctn)	
FLOPKM60	0.37	0.5	35	35	8	1"x1"	5.5	430 x 285 x 345	6	4050
FLOPKM70	0.55	0.75	45	48	8	1"x1"	9	370 x 340 x 220	2	2100
FLOPKM80	0.75	1	50	60	8	1"x1"	10	370 x 340 x 220	2	2100

FLO IDB/PM SERIES

PERIPHERAL PUMPS

OPERATING LIMITS

- Max. suction: 8 m
- Max. medium temperature: +60°C
- Max. ambient temperature: +40°C
- Max. pressure: 6 bar

MATERIAL

- Pump body: Cast iron, with brass/ AISI304 SS insert if request
- Pump support: Cast iron, with brass/ AISI304 SS insert if request
- Motor housing: Aluminum
- Impeller: Brass
- Motor wire: copper
- Mechanical seal: Graphite&Ceramic
- Shaft: AISI304/stainless steel

MOTOR INFORMATION

- Two-pole induction motor
- Single phase/three phase, 50/60Hz (on demand)
- Thermal protector for single phase
- Insulation class: B
- Protection class: IP 44



IDB-35



PM45

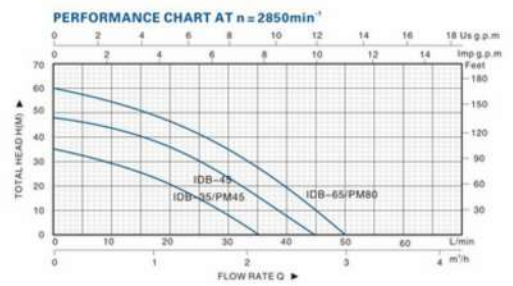

TECHNICAL DATA

Model	Power		Q. Max (L/min)	H. Max (m)	S. Max (m)	Inlet/Outlet (inch)	G.W. (kg)	Packing dimension		20GP (pcs)
	(Kw)	(HP)						(mm)	(pcs/ctn)	
FLOIDB-35	0.37	0.5	35	35	8	1"x1"	5.5	430 x 285 x 345	6	4050
FLOIDB-45	0.55	0.75	45	48	8	1"x1"	9	370 x 340 x 220	2	2100
FLOIDB-65	0.75	1	50	60	8	1"x1"	10	370 x 340 x 220	2	2100
FLOPM45	0.37	0.5	35	35	8	1"x1"	5.5	430 x 285 x 345	6	4050
FLOPM80	0.75	1	50	60	8	1"x1"	10	370 x 340 x 220	2	2100

FLO IZDB SERIES

SELF-PRIMING PERIPHERAL PUMPS

OPERATING LIMITS

- Max. suction: 8 m
- Max. medium temperature: +60°C
- Max. ambient temperature: +40°C
- Max. pressure: 6 bar

MATERIAL

- Pump body: Cast iron, with brass/ AISI304 SS insert if request
- Pump support: Cast iron, with brass/ AISI304 SS insert if request
- Motor housing: Aluminum
- Impeller: Brass
- Motor wire: copper
- Mechanical seal: Graphite&Ceramic
- Shaft: AISI304/stainless steel

MOTOR INFORMATION

- Two-pole induction motor
- Single phase/three phase, 50/60Hz (on demand)
- Thermal protector for single phase
- Insulation class: B
- Protection class: IP 44



IZDB

PERFORMANCE CHART AT $n = 2850 \text{ min}^{-1}$

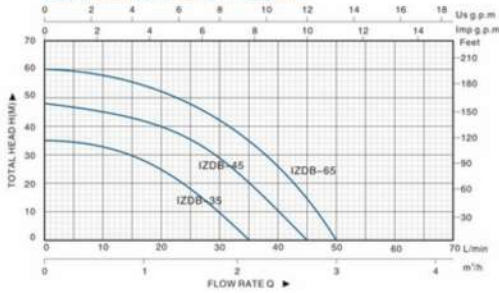

TECHNICAL DATA

Model	Power		Q. Max (L/min)	H. Max (m)	S. Max (m)	Inlet/Outlet (inch)	G.W. (kg)	Packing dimension (mm)	20GP (pcs)
	(Kw)	(HP)							
FLO IZDB-35	0.37	0.5	35	35	8	1"x1"	6.5	270 x 195 x 235	2300
FLO IZDB-45	0.55	0.75	45	48	8	1"x1"	10	300 x 198 x 258	1900
FLO IZDB-65	0.75	1	50	60	8	1"x1"	11	300 x 198 x 258	1900

FLO WZB SERIES

SELF-PRIMING PERIPHERAL PUMPS

OPERATING LIMITS

- Max. suction: 8 m
- Max. medium temperature: +60°C
- Max. ambient temperature: +40°C
- Max. pressure: 6 bar

MATERIAL

- Pump body: Cast iron with AISI304 SS insert
- Pump support: Cast iron with AISI304 SS insert
- Motor housing: Aluminum
- Impeller: Brass
- Motor wire: copper
- Mechanical seal: Graphite&Ceramic
- Shaft: AISI304/stainless steel

MOTOR INFORMATION

- Two-pole induction motor
- Single phase/three phase, 50/60Hz (on demand)
- Thermal protector for single phase
- Insulation class: B
- Protection class: IP 44



WZB



WZB-A

PERFORMANCE CHART AT $n = 2850 \text{ min}^{-1}$

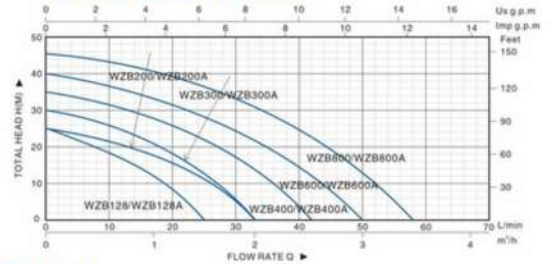

TECHNICAL DATA

Model	Power		Q. Max (m³/h)	H. Max (m)	S. Max (m)	Inlet/Outlet (inch)	Pressure Switch (kg/cm²)	N.W. (kg)	Packing dimension (mm)	20GP (pcs)
	(Kw)	(HP)								
FLO WZB128	0.158	0.17	1.5	25	8	1"x1"	/	6.8	290 x 210 x 280	1700
FLO WZB128A	0.2	0.27	1.5	25	8	1"x1"	1.2	7.2	310 x 250 x 310	1200
FLO WZB200	0.2	0.27	2.0	25	8	1"x1"	/	8	290 x 210 x 280	1700
FLO WZB200A	0.2	0.27	2.0	25	8	1"x1"	1.5	8.6	310 x 250 x 310	1200
FLO WZB300	0.3	0.4	2.0	30	8	1"x1"	/	8.5	290 x 210 x 280	1700
FLO WZB300A	0.3	0.4	2.0	30	8	1"x1"	1.8	9.1	310 x 250 x 310	1200
FLO WZB400	0.4	0.53	2.5	35	8	1"x1"	/	8.6	290 x 210 x 280	1700
FLO WZB400A	0.4	0.53	2.5	35	8	1"x1"	2.2	9.4	310 x 250 x 310	1200
FLO WZB600	0.6	0.8	3.0	40	8	1"x1"	/	11.4	330 x 260 x 300	1100
WZB600A	0.6	0.8	3.0	40	8	1"x1"	2.6	12.2	350 x 260 x 330	900
WZB800	0.6	1.1	3.5	45	8	1"x1"	/	12.8	330 x 260 x 300	1100
WZB800A	0.8	1.1	3.5	45	8	1"x1"	3.1	13.6	350 x 260 x 330	900

FLOWZB SERIES

SELF-PRIMING PERIPHERAL PUMPS

OPERATING LIMITS

- Max. suction: 8 m
- Max. medium temperature: +60°C
- Max. ambient temperature: +40°C
- Max. pressure: 6 bar

MATERIAL

- Pump body: Cast iron, with AISI304 SS insert if request
- Pump support: Cast iron, with AISI304 SS insert if request
- Motor housing: Aluminum
- Impeller: Brass
- Motor wire: copper
- Mechanical seal: Graphite&Ceramic
- Shaft: AISI316/stainless steel

MOTOR INFORMATION

- Two-pole induction motor
- Single phase/three phase, 50/60Hz (on demand)
- Thermal protector for single phase
- Insulation class: B
- Protection class: IP 44

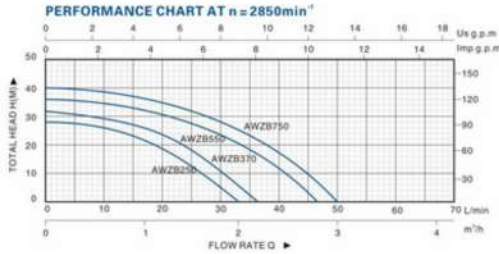

TECHNICAL DATA

Model	Power		Q. Max (m³/h)	H. Max (m)	S. Max (m)	Inlet/Outlet (inch)	G.W. (kg)	Packing dimension (mm)	20GP (pcs)
	(Kw)	(HP)							
FLOWZB250	0.25	0.33	2.0	28	8	1"x1"	7.6	295 x 220 x 278	1600
FLOWZB370	0.37	0.5	2.2	32	8	1"x1"	8	295 x 220 x 278	1600
FLOWZB550	0.55	0.75	2.8	36	8	1"x1"	11.8	320 x 240 x 340	1100
FLOWZB750	0.75	1	3.0	40	8	1"x1"	12.3	320 x 240 x 340	1100

FLOPW SERIES

SELF-PRIMING PERIPHERAL PUMPS

OPERATING LIMITS

- Max. suction: 8 m
- Max. medium temperature: +40°C
- Max. ambient temperature: +40°C
- Max. pressure: 6 bar

MATERIAL

- Pump body: Cast iron with AISI304 SS insert
- Pump support: Cast iron with AISI304 SS insert
- Motor housing: Aluminum
- Impeller: Brass
- Motor wire: copper
- Mechanical seal: Graphite&Ceramic
- Shaft: AISI316/stainless steel

MOTOR INFORMATION

- Two-pole induction motor
- Single phase/three phase, 50/60Hz (on demand)
- Thermal protector for single phase
- Insulation class: B
- Protection class: IP 44

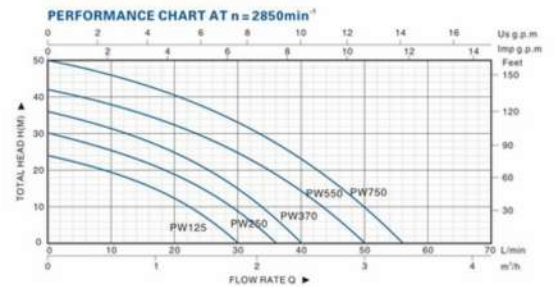

TECHNICAL DATA

Model	Power		Q. Max (m³/h)	H. Max (m)	S. Max (m)	Inlet/Outlet (inch)	G.W. (kg)	Packing dimension (mm)	20GP (pcs)
	(Kw)	(HP)							
FLOPW125	0.125	0.17	1.8	24	8	1"x1"	8.1	295 x 210 x 285	1600
FLOPW250	0.25	0.33	2.2	30	8	1"x1"	8.5	295 x 210 x 285	1600
FLOPW370	0.37	0.5	2.4	36	8	1"x1"	8.7	295 x 210 x 285	1600
FLOPW550	0.55	0.75	3.0	42	8	1"x1"	12	325 x 240 x 325	1100
FLOPW750	0.75	1	3.4	50	8	1"x1"	14	325 x 240 x 325	1100

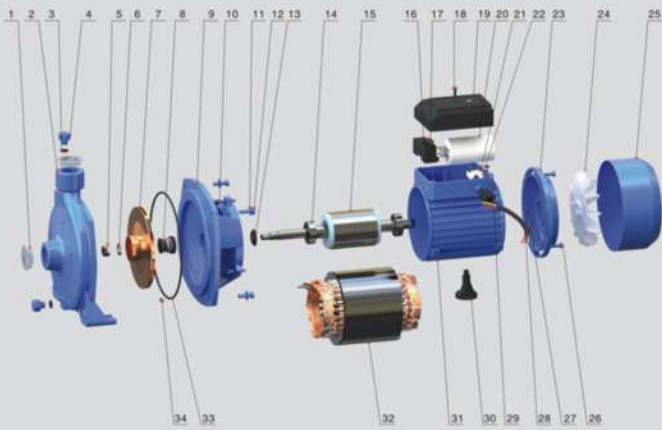

TECHNICAL DATA

No.	Description	No.	Description	No.	Description
1	Dustproof cover	13	Water proof gland	25	Fan cover
2	Pump body	14	Bearing	26	Bolt
3	O ring	15	Rotor	27	Spring Washer
4	Filling plug	16	Terminal board	28	Cable
5	Lock Nut	17	Bolt	29	Cable holder
6	Spring washer	18	Bolt	30	Foot
7	Impeller	19	Terminal box	31	Motor housing
8	Mechanical seal	20	Capacitor	32	Stator
9	Pump support	21	Bolt	33	O ring
10	Bolt	22	Cord clip	34	Key
11	Washer	23	Motor cover		
12	Bolt	24	Fan		

FLOCPM SERIES

CENTRIFUGAL PUMPS

OPERATING LIMITS

- Max. suction: 8 m
- Max. medium temperature: +40°C
- Max. ambient temperature: +40°C
- Max. pressure: 6 bar
- Transport medium: FH6.5-8.5

MATERIAL

- Pump body: Cast iron
- Pump support: Cast iron
- Motor housing: Aluminum
- Impeller: Brass/PPG
- Motor wire: copper
- Mechanical seal: Ceramic/Graphite
- Shaft: 45#steel/stainless steel

MOTOR INFORMATION

- Two-pole induction motor
- Single phase/three phase, 50/60Hz (on demand)
- Thermal protector for single phase
- Insulation class: B
- Protection class: IP 44

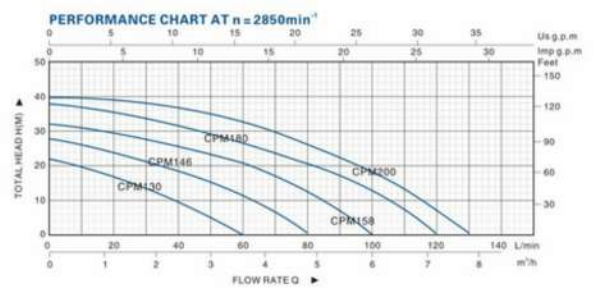

TECHNICAL DATA

Model	Power		Q. Max (L/min)	H. Max (m)	S. Max (m)	Inlet/Outlet (inch)	G.W. (kg)	Packing dimension (mm)	20GP (pcs)
	(Kw)	(HP)							
FLOCPM130	0.37	0.5	60	22	8	1"x1"	7.8	280 x 175 x 225	2600
FLOCPM146	0.55	0.75	80	28	8	1"x1"	11	330 x 205 x 265	1600
FLOCPM158	0.75	1	100	32	8	1"x1"	12	330 x 205 x 265	1600
FLOCPM180	1.1	1.5	120	38	8	1.25"x1"	21.5	395 x 270 x 325	840
FLOCPM200	1.5	2	130	40	8	1"x1"	22.5	395 x 270 x 325	840

FLOSCM SERIES

CENTRIFUGAL PUMPS

OPERATING LIMITS

- Max. suction: 8 m
- Max. medium temperature: +60°C
- Max. ambient temperature: +40°C
- Max. pressure: 6 bar
- Transport medium: FH6.5-8.5

MATERIAL

- Pump body: Cast iron
- Pump support: Cast iron
- Motor housing: Aluminum
- Impeller: Brass/PPD
- Motor wire: copper
- Mechanical seal: Ceramic&Graphite
- Shaft: 45#steel/stainless steel

MOTOR INFORMATION

- Two-pole induction motor
- Single phase/three phase, 50/60Hz (on demand)
- Thermal protector for single phase
- Insulation class: B
- Protection class: IP44



SCM

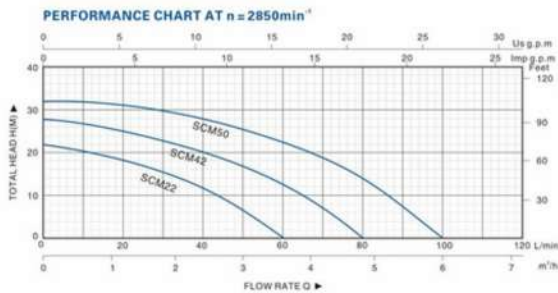

TECHNICAL DATA

Model	Power		Q. Max (L/min)	H. Max (m)	S. Max (m)	Inlet/Outlet (inch)	G.W. (kg)	Packing dimension (mm)	20GP (pcs)
	(Kw)	(HP)							
FLOSCM22	0.37	0.5	60	22	8	1"x1"	7.8	280 x 175 x 225	2600
FLOSCM42	0.55	0.75	80	28	8	1"x1"	11	330 x 205 x 265	1600
FLOSCM50	0.75	1	100	32	8	1"x1"	12	330 x 205 x 265	1600

FLOCB SERIES

CENTRIFUGAL PUMPS

OPERATING LIMITS

- Max. suction: 8 m
- Max. medium temperature: +40°C
- Max. ambient temperature: +40°C
- Max. pressure: 6 bar

MATERIAL

- Pump body: Cast iron
- Pump support: Cast iron
- Motor housing: Aluminum
- Impeller: Stainless steel/PPD
- Motor wire: Copper
- Mechanical seal: Graphite&Ceramic
- Shaft: 45#steel/stainless steel

MOTOR INFORMATION

- Two-pole induction motor
- Single phase/three phase, 50/60Hz (on demand)
- Thermal protector for single phase
- Insulation class: B
- Protection class: IP44



CB

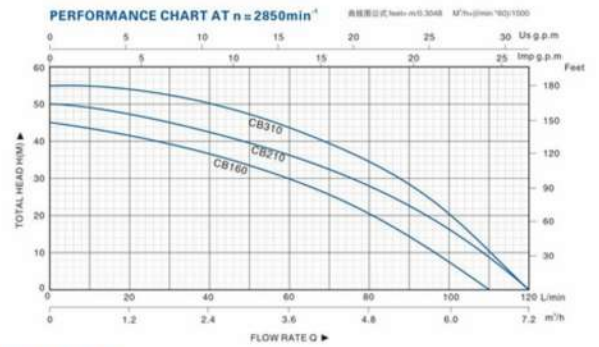

TECHNICAL DATA

Model	Power		Q. Max (L/min)	H. Max (m)	S. Max (m)	Inlet/Outlet (inch)	G.W. (kg)	Packing dimension (mm)	20GP (pcs)
	(Kw)	(HP)							
FLOCB160	1.1	1.5	110	45	8	1.25"x1"	22	465 x 250 x 290	860
FLOCB210	1.5	2	120	50	8	1.25"x1"	23	465 x 250 x 290	860
FLOCB310	2.2	3	120	55	8	1.25"x1"	24	465 x 250 x 290	860

FLODMC SERIES

MULTISTAGE CENTRIFUGAL PUMPS

OPERATING LIMITS

- Max. suction: 8 m
- Max. medium temperature: +40°C
- Max. ambient temperature: +40°C
- Max. pressure: 6 bar
- Transport medium: PH6.5-8.5

MATERIAL

- Pump body: Cast iron
- Pump support: Cast iron
- Motor housing: Aluminum
- Impeller: Stainless Steel/PPD
- Motor wire: copper
- Mechanical seal: Ceramic&Graphite
- Shaft: 45#steel/stainless steel

MOTOR INFORMATION

- Two-pole induction motor
- Single phase/three phase, 50/60Hz (on demand)
- Thermal protector for single phase
- Insulation class: B
- Protection class: IP44

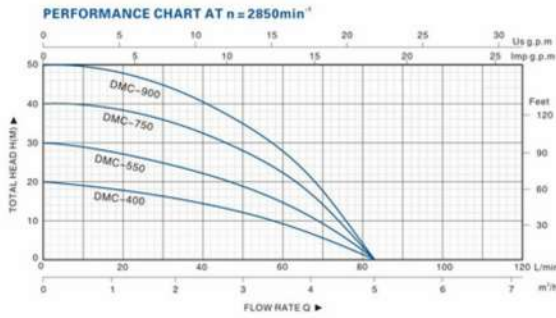

TECHNICAL DATA

Model	Power		Q. Max (L/min)	H. Max (m)	S. Max (m)	Inlet/Outlet (inch)	G. W. (kg)	Packing dimension (mm)	20GP (pcs)
	(Kw)	(HP)							
DMC-400	0.45	0.6	83	20	8	1"x1"	11	380 x 185 x 195	2110
DMC-550	0.55	0.75	83	30	8	1"x1"	12	405 x 185 x 195	1980
DMC-750	0.75	1	83	40	8	1"x1"	13	430 x 185 x 195	1860
DMC-900	1	1.3	83	50	8	1"x1"	14	455 x 185 x 195	1760

FLOAUTO SERIES

WATER PUMPS

OPERATING LIMITS

- Max. suction: 8 m
- Max. medium temperature: +40°C
- Max. ambient temperature: +40°C
- Max. pressure: 6 bar

MATERIAL

- Pump body: Cast iron
- Pump support: Cast iron
- Motor housing: Aluminum
- Impeller: Brass/PPD
- Motor wire: Copper
- Mechanical seal: Graphite&Ceramic
- Shaft: 45#steel/stainless steel

MOTOR INFORMATION

- Two-pole induction motor
- Single phase/three phase, 50/60Hz (on demand)
- Thermal protector for single phase
- Insulation class: B
- Protection class: IP44



TECHNICAL DATA

Model	Power		Q. Max (L/min)	H. Max (m)	S. Max (m)	Inlet/Outlet (inch)	Tank Capacity (L)	Tank Located	Suggested Pressure Setting Bar	G. W. (kg)	Packing dimension (mm)	20GP (pcs)
	(Kw)	(HP)										
AUJET60S	0.37	0.5	40	35	9	1"x1"	24L	Horizontal	1.2-2.4	18	540 x 380 x 535	250
AUJET80S	0.55	0.75	50	44	9	1"x1"	24L	Horizontal	1.4-2.8	19	540 x 380 x 535	250
AUJET100S	0.75	1	60	48	9	1"x1"	24L	Horizontal	1.4-2.8	20	540 x 380 x 535	250
AUJET80L	0.55	0.75	50	44	9	1"x1"	24L	Horizontal	1.4-2.8	20	540 x 380 x 535	250
AUJET100L	0.75	1	60	48	9	1"x1"	24L	Horizontal	1.4-2.8	21	540 x 380 x 535	250
AUJS60S	0.37	0.5	40	28	9	1"x1"	24L	Horizontal	1.2-2.4	13.5	540 x 380 x 535	250
AUJS80S	0.55	0.75	50	44	9	1"x1"	24L	Horizontal	1.4-2.8	16	540 x 380 x 535	250
AUJS100S	0.75	1	60	48	9	1"x1"	24L	Horizontal	1.4-2.8	17	540 x 380 x 535	250
AUQB60	0.37	0.5	35	35	8	1"x1"	24L	Horizontal	1.2-2.2	10	530 x 325 x 555	300
AUQB70	0.55	0.75	45	48	8	1"x1"	24L	Horizontal	1.4-2.8	14	530 x 325 x 595	280
AUQB80	0.75	1	50	60	8	1"x1"	24L	Horizontal	1.4-2.8	15	530 x 325 x 595	280

FLOCPS SERIES

CENTRIFUGAL PUMPS

OPERATING LIMITS

- Max. suction: 8 m
- Max. medium temperature: +60°C
- Max. ambient temperature: +40°C
- Max. pressure: 6 bar

MATERIAL

- Pump body: Stainless steel
- Pump support: Aluminum
- Motor housing: Aluminum
- Impeller: Stainless steel/PPD
- Motor wire: Copper
- Mechanical seal: Graphite&Ceramic
- Shaft: AISI304 stainless steel

MOTOR INFORMATION

- Two-pole induction motor
- Single phase/three phase, 50/60Hz (on demand)
- Thermal protector for single phase
- Insulation class: B
- Protection class: IP44



CPS

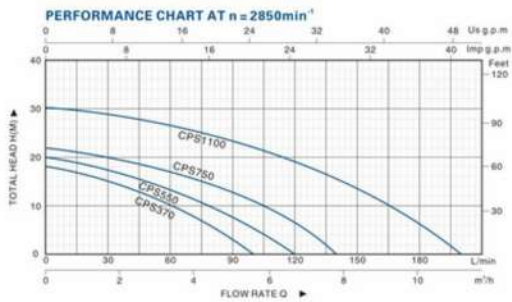

TECHNICAL DATA

Model	Power		Q. Max (L/min)	H. Max (m)	S. Max (m)	Inlet/Outlet (inch)	G.W. (kg)	Packing dimension (mm)	20GP (pcs)
	(Kw)	(HP)							
FLOCPS370	0.37	0.5	100	18	8	1.25"x1"	8	345 x 230 x 265	1400
FLOCPS550	0.55	0.75	120	20	8	1.25"x1"	9	345 x 230 x 265	1400
FLOCPS750	0.75	1	140	22	8	1.25"x1"	9.7	345 x 230 x 265	1400
FLOCPS1100	1.1	1.5	200	30	8	1.25"x1"	16	390 x 265 x 290	970

FLODK SERIES

CENTRIFUGAL PUMPS

OPERATING LIMITS

- Max. suction: 8 m
- Max. medium temperature: +40°C
- Max. ambient temperature: +40°C
- Max. pressure: 6 bar
- Transport medium: FH6.5-8.5

MATERIAL

- Pump body: Cast iron
- Pump support: Cast iron
- Motor housing: Aluminum
- Impeller: Brass/PPD
- Motor wire: Copper
- Mechanical seal: Ceramic&Graphite
- Shaft: AISI304 stainless steel

MOTOR INFORMATION

- Two-pole induction motor
- Single phase/three phase, 50/60Hz (on demand)
- Thermal protector for single phase
- Insulation class: B
- Protection class: IP44



1DK-14



2DK-16

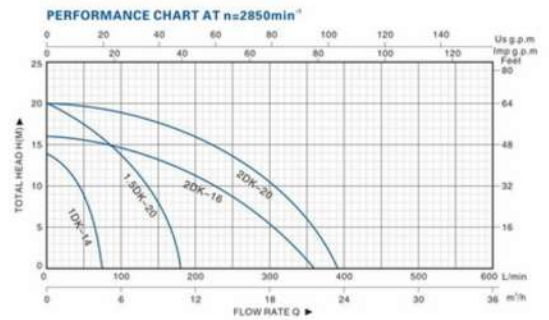

TECHNICAL DATA

Model	Power		Q. Max (L/min)	H. Max (m)	S. Max (m)	Inlet/Outlet (inch)	G.W. (kg)	Packing dimension (mm)	20GP (pcs)
	(Kw)	(HP)							
FLO1DK-14	0.37	0.5	75	14	9	1"x1"	7.3	285 x 170 x 200	2900
FLO1BDK-20	0.75	1	180	20	9	1.5"x1.5"	10.7	315 x 175 x 210	2500
FLO2DK-16	1.1	1.5	360	16	9	2"x2"	16	425 x 220 x 265	1100
FLO2DK-20	1.5	2	390	20	9	2"x2"	17	425 x 220 x 265	1100

FLOHFM SERIES

CENTRIFUGAL PUMPS

OPERATING LIMITS

- Max. suction: 8 m
- Max. medium temperature: +60°C
- Max. ambient temperature: +40°C
- Max. pressure: 6 bar
- Transport medium: FH6.5-6.5

MATERIAL

- Pump body: Cast iron
- Pump support: Cast iron
- Motor housing: Aluminum
- Impeller: Brass/PPC
- Motor wire: Copper
- Mechanical seal: Ceramic&Graphite
- Shaft: AISI304/stainless steel

MOTOR INFORMATION

- Two-pole induction motor
- Single phase/Three phase, 50/60Hz (on demand)
- Thermal protector for single phase
- Insulation class: B
- Protection class: IP44

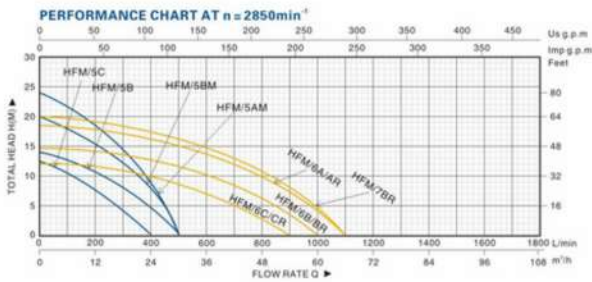

TECHNICAL DATA

Model	Power		Q. Max (L/min)	H. Max (m)	S. Max (m)	Inlet/Outlet (inch)	G.W. (kg)	Packing dimension (mm)	20GP (pcs)
	(Kw)	(HP)							
HFM/SC	0.55	0.75	400	12.5	8	2"x2"	14.8	355 x 220 x 270	1300
HFM/SB	0.75	1	500	14	8	2"x2"	15.7	355 x 220 x 270	1200
HFM/SBM	1.1	1.5	500	20	8	2"x2"	19	410 x 240 x 300	980
HFM/SAM	1.5	2	500	24	8	2"x2"	21	410 x 240 x 300	980
HFM/SC	1.1	2	900	12	8	3"x3"	29	450 x 260 x 350	700
HFM/BCR	1.1	2	900	12	8	4"x4"	30	450 x 260 x 350	700
HFM/BB	1.5	2	1000	14.7	8	3"x3"	30	450 x 260 x 350	700
HFM/BBR	1.5	2	1000	14.7	8	4"x4"	31	450 x 260 x 350	700
HFM/BA	2.2	3	1100	18.5	8	3"x3"	38	500 x 290 x 360	500
HFM/BAAR	2.2	3	1100	18.5	8	4"x4"	39	500 x 290 x 360	500
HFM/TBR	3	4	1100	20	8	4"x4"	42	500 x 290 x 360	450

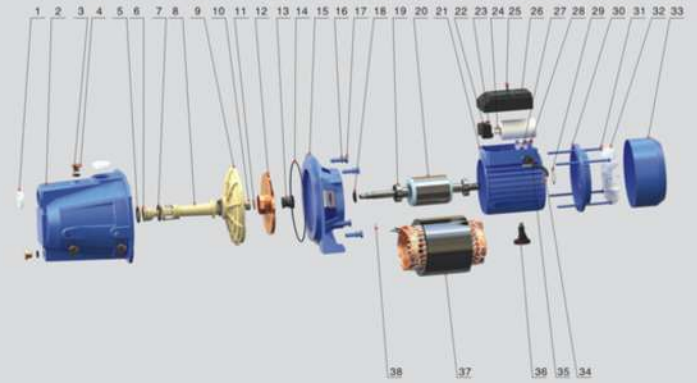

TECHNICAL DATA

No.	Description	No.	Description	No.	Description	No.	Description
1	Dustproof cover	12	Impeller	23	Bolt	34	Cable
2	Pump body	13	Mechanical seal	24	Capacitor	35	Cable holder
3	O ring	14	O Ring	25	Bolt	36	Foot
4	Filling plug	15	Pump support	26	Terminal box	37	Stator
5	O ring	16	Washer	27	Cord clip	38	Key
6	Nozzle	17	Bolt	28	Bolt		
7	O ring	18	Water proof gland	29	Spring Washer		
8	Venturi pipe	19	Bearing	30	Motor cover		
9	Diffuser	20	Rotor	31	Bolt		
10	Lock Nut	21	Motor housing	32	Fan		
11	Spring Washer	22	Terminal board	33	Fan cover		

FLOJETS SERIES

SELF-PRIMING JET PUMPS

OPERATING LIMITS

- Max. suction: 8 m
- Max. medium temperature: +60°C
- Max. ambient temperature: +40°C
- Max. pressure: 6 bar
- Transport medium: FHB-8.5

MATERIAL

- Pump body: Cast iron
- Pump support: Cast iron
- Motor housing: Aluminum
- Impeller: Brass/PPD
- Mechanical seal: Ceramic & Graphite
- Shaft: AISI steel/stainless steel

MOTOR INFORMATION

- Two-pole induction motor
- Single phase/three phase, 50/60Hz (on demand)
- Thermal protector for single phase
- Insulation class: B
- Protection class: IP44



JETS

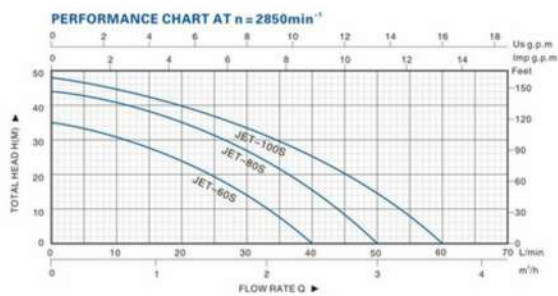

TECHNICAL DATA

Model	Power		Q. Max (L/min)	H. Max (m)	S. Max (m)	Inlet/Outlet (inch)	G.W. (kg)	Packing dimension (mm)	20GP (pcs)
	(Kw)	(HP)							
FLOJET-60S	0.37	0.5	40	35	9	1"x1"	12	415 x 190 x 215	1700
FLOJET-80S	0.6	0.8	50	44	9	1"x1"	13	415 x 190 x 215	1700
FLOJET-100S	0.75	1	60	48	9	1"x1"	14	415 x 190 x 215	1700

FLOJETM/JETL/JETP SERIES

SELF-PRIMING JET PUMPS

OPERATING LIMITS

- Max. suction: 8 m
- Max. medium temperature: +60°C
- Max. ambient temperature: +40°C
- Max. pressure: 6 bar
- Transport medium: FHB-8.5

MATERIAL

- Pump body: Cast iron
- Pump support: Cast iron
- Motor housing: Aluminum
- Impeller: Brass/PPD
- Mechanical seal: Ceramic & Graphite
- Shaft: AISI steel/stainless steel

MOTOR INFORMATION

- Two-pole induction motor
- Single phase/three phase, 50/60Hz (on demand)
- Thermal protector for single phase
- Insulation class: B
- Protection class: IP44



JET-L



JET-M



JET-P

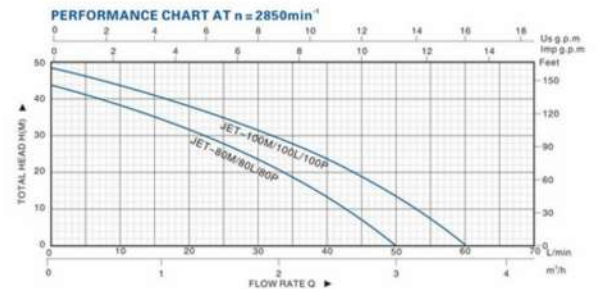

TECHNICAL DATA

Model	Power		Q. Max (L/min)	H. Max (m)	S. Max (m)	Inlet/Outlet (inch)	G.W. (kg)	Packing dimension (mm)	20GP (pcs)
	(Kw)	(HP)							
FLOJET-80L	0.55	0.75	50	44	9	1"x1"	14	465 x 190 x 215	1500
FLOJET-100L	0.75	1	60	48	9	1"x1"	15	465 x 190 x 215	1500
FLOJET-80M	0.55	0.75	50	44	9	1"x1"	14	465 x 190 x 215	1500
FLOJET-100M	0.75	1	60	48	9	1"x1"	15	465 x 190 x 215	1500
FLOJET-80P	0.55	0.75	50	44	9	1"x1"	14	465 x 190 x 215	1500
FLOJET-100P	0.75	1	60	48	9	1"x1"	15	465 x 190 x 215	1500

FLOJSW SERIES

SELF-PRIMING JET PUMPS

OPERATING LIMITS

- Max. suction: 9 m
- Max. medium temperature: +60°C
- Max. ambient temperature: +40°C
- Max. pressure: 6 bar
- Transport medium: FNB-8.5

MATERIAL

- Pump body: Cast iron
- Pump support: Cast iron / Aluminum
- Motor housing: Aluminum
- Impeller: Brass
- Mechanical seal: Ceramic & Graphite
- Shaft: AISI304/stainless steel

MOTOR INFORMATION

- Two-pole induction motor
- Single phase/three phase, 50/60Hz (on demand)
- Thermal protector for single phase
- Insulation class: B
- Protection class: IP44



JSW

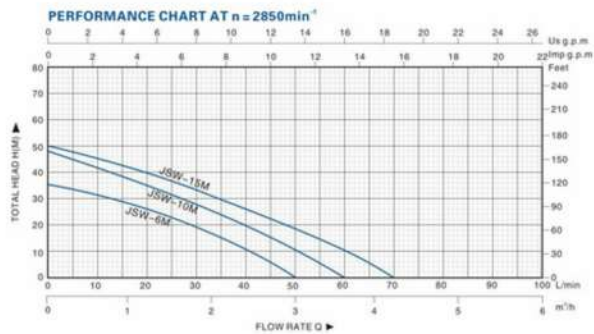

TECHNICAL DATA

Model	Power		Q. Max (L/min)	H. Max (m)	S. Max (m)	Inlet/Outlet (inch)	G.W. (kg)	Packing dimension (mm)	20GP (pcs)
	(Kw)	(HP)							
FLOJSW-6M	0.37	0.5	50	35	9	1"x1"	9.5	390 x 185 x 220	1800
FLOJSW-10M	0.75	1	60	48	9	1"x1"	15	450 x 190 x 230	1500
FLOJSW-15M	1.1	1.5	70	50	9	1"x1"	15.5	465 x 190 x 230	1400

FLOSWP SERIES

SELF-PRIMING JET PUMPS

OPERATING LIMITS

- Max. suction: 9 m
- Max. medium temperature: +60°C
- Max. ambient temperature: +40°C
- Max. pressure: 6 bar
- Transport medium: FNB-8.5

MATERIAL

- Pump body: Cast iron
- Pump support: Cast iron
- Motor housing: Aluminum
- Impeller: Brass
- Mechanical seal: Ceramic & Graphite
- Shaft: AISI304/stainless steel

MOTOR INFORMATION

- Two-pole induction motor
- Single phase/three phase, 50/60Hz (on demand)
- Thermal protector for single phase
- Insulation class: B
- Protection class: IP44



SWP

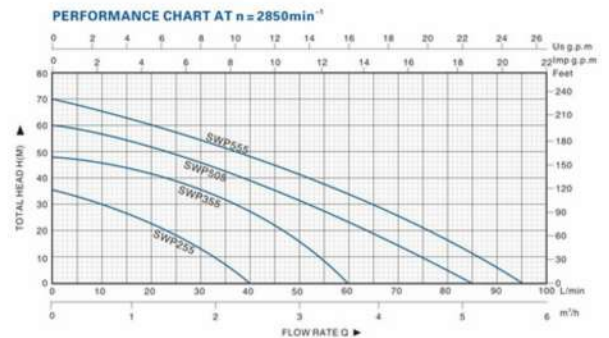

TECHNICAL DATA

Model	Power		Q. Max (L/min)	H. Max (m)	S. Max (m)	Inlet/Outlet (inch)	G.W. (kg)	Packing dimension (mm)	20GP (pcs)
	(Kw)	(HP)							
FLOSWP255	0.37	0.5	40	35	9	1"x1"	12.5	458 x 200 x 230	1300
FLOSWP355	0.75	1	60	48	9	1"x1"	13.5	458 x 200 x 230	1300
FLOSWP505	1.1	1.5	85	60	9	1.25"x1"	25	540 x 235 x 260	800
FLOSWP555	1.5	2	95	70	9	1.25"x1"	26	540 x 235 x 260	800

FLOJS SERIES SELF-PRIMING JET PUMPS

OPERATING LIMITS

- Max. suction: 9 m
- Max. medium temperature: 40°C
- Max. ambient temperature: 40°C
- Max. pressure: 6 bar
- Transport medium: FH5-S-8.5

MATERIAL

- Pump body: Stainless Steel
- Pump support: Aluminum
- Motor housing: Aluminum
- Impeller: Stainless Steel / PPO
- Motor wire: Copper
- Mechanical seal: Ceramic & Graphite
- Shaft: 45#steel/stainless steel

MOTOR INFORMATION

- Two-pole induction motor
- Single phase/three phase, 50/60Hz (on demand)
- Thermal protector for single phase
- Insulation class: B
- Protection class: IP44



JS

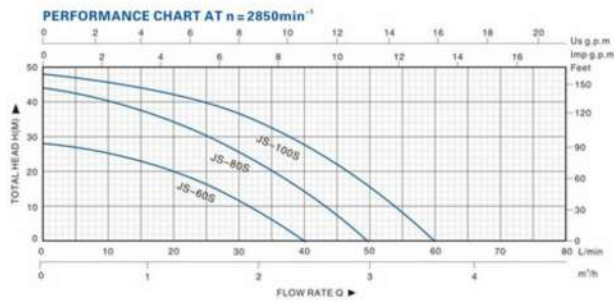

TECHNICAL DATA

Model	Power		Q. Max (L/min)	H. Max (m)	S. Max (m)	Inlet/Outlet (inch)	G.W. (kg)	Packing dimension (mm)	20GP (pcs)
	(Kw)	(HP)							
FLOJS-60S	0.37	0.55	40	28	9	1"x1"	7	395 x 220 x 245	1300
FLOJS-80S	0.55	0.75	50	44	9	1"x1"	10	395 x 220 x 245	1300
FLOJS-100S	0.75	1	60	48	9	1"x1"	11	395 x 220 x 245	1300

FLODP SERIES SELF-PRIMING JET PUMPS

OPERATING LIMITS

- Max. suction: 12 m
- Max. medium temperature: 40°C
- Max. ambient temperature: 40°C
- Transport medium: FH5-S-8.5

MATERIAL

- Pump body: Cast Iron
- Motor housing: Aluminum
- Impeller: Brass
- Mechanical seal: Ceramic & Graphite
- Shaft: 45#steel/stainless steel

MOTOR INFORMATION

- Two-pole induction motor
- Single phase/three phase, 50/60Hz (on demand)
- Thermal protector for single phase
- Insulation class: B
- Protection class: IP44



DP255



DP505



TECHNICAL DATA

Model	Power		Q. Max (L/min)	H. Max (m)	S. Max (m)	Inlet/Outlet (inch)	G.W. (kg)	Packing dimension (mm)	20GP (pcs)
	(Kw)	(HP)							
FLODP255	0.55	0.75	30	35	15	1.25"x1"x1"	16	423 x 288 x 245	970
FLODP370	0.75	1	35	50	20	1.25"x1"x1"	19	423 x 288 x 245	970
FLODP505	1.1	1.5	50	70	20	1.25"x1"x1"	32.2	525 x 235 x 295	600

SUBMERSIBLE PUMPS



FLOQDX SERIES SUBMERSIBLE PUMPS

OPERATING LIMITS

- Max. medium temperature+40°C
- Max. ambient temperature+40°C
- PH level from 5.5-8.5
- Maximum sand content is 0.1%.
- Passage of suspended solids up to 0.2mm.
- Voltage fluctuation range: 0.9-1.1 times of the rated value
- Immersion depth from 0.5m-5m

MATERIAL

- Pump body: Cast iron
- Motor housing: Aluminum/iron
- Impeller: Aluminum
- Motor wire: Copper
- Mechanical seal: Ceramic/Graphite
- Shaft: 416steel/stainless steel

MOTOR INFORMATION

- Two-pole induction motor
- Single phase/three phase,
- 50/60Hz (on demand)
- Thermal protector for single phase
- Insulation class: B
- Protection class: IPX8

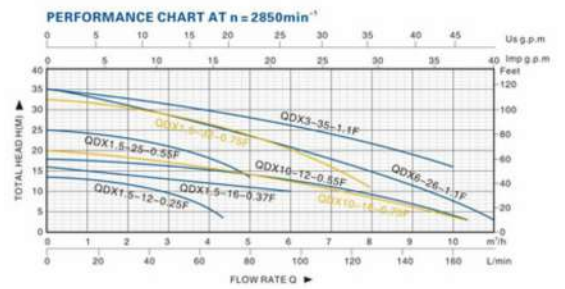

TECHNICAL DATA

Model	Power		Q. Rated (m³/h)	H. Rated (m)	Inlet/Outlet (inch)	G.W. (kg)	Packing dimension (mm)	ZPGP (pcs)
	(Kw)	(HP)						
QDX1.5-12-0.25F	0.25	0.37	4.7	13	1"	6.5	380 x 160 x 190	2500
QDX1.5-16-0.37F	0.37	0.5	6	18	1"	7.5	380 x 160 x 190	2500
QDX1.5-25-0.55F	0.55	0.75	6.5	26	1"	10	390 x 180 x 200	1900
QDX3-18-0.55F	0.55	0.75	8	20	1.25"	10	390 x 180 x 200	1900
QDX10-12-0.55F	0.55	0.75	14	15	1.5"	10	390 x 180 x 200	1900
QDX15-7-0.55F	0.55	0.75	22	8	2"	10	390 x 180 x 200	1900
QDX1.5-32-0.75F	0.75	1	7	32	1"	12	410 x 195 x 220	1600
QDX8-18-0.75F	0.75	1	15	20	1.5"	11.5	410 x 195 x 220	1600
QDX10-16-0.75F	0.75	1	20	20	2"	11.5	410 x 195 x 220	1600
QDX15-10-0.75F	0.75	1	26	10	2.5"	12	410 x 195 x 220	1600
QDX25-6-0.75F	0.75	1	32	9.5	3"	12	470 x 210 x 280	1600
QDX3-35-1.1F	1.1	1.5	8	37	1"	13.5	455 x 205 x 210	1400
QDX6-26-1.1F	1.1	1.5	14	27	1.5"	14	470 x 240 x 200	1200
QDX15-14-1.1F	1.1	1.5	28	17	2.5"	15	470 x 260 x 185	1200
QDX40-6-1.1F	1.1	1.5	50	10	3"	15.5	500 x 280 x 210	1000
QDX25-12-1.5F	1.5	2	42	15	2.5"	17.5	500 x 280 x 210	800
QDX40-9-1.5F	1.5	2	55	12	3"	18	500 x 280 x 210	800

SUBMERSIBLE PUMPS



FLOQDX-T/S SERIES

SUBMERSIBLE PUMPS

OPERATING LIMITS

- Max. medium temperature: 40°C
- Max. ambient temperature: 40°C
- PH level from 6.5 - 8.5
- Maximum sand content is 0.1%. Passage of suspended solids up to 0.2mm.
- Voltage fluctuation range: 0.9-1.1 times of the rated value
- Immersion depth from 0.5m-5m

MATERIAL

- Pump body: Cast iron
- Motor housing: Cast iron/Stainless steel
- Impeller: Aluminum
- Motor wire: Copper
- Mechanical seal: Ceramic/Graphite
- Shaft: 45steel/stainless steel

MOTOR INFORMATION

- Two-pole induction motor
- Single phase/three phase, 50/60Hz (on demand)
- Thermal protector for single phase
- Insulation class: B
- Protection class: IPX8

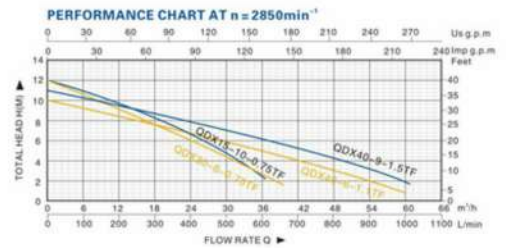

TECHNICAL DATA

Model	Power		Q. Rated (m³/h)	H. Rated (m)	Inlet/Outlet (inch)	G.W. (kg)	Packing dimension (mm)	26GP (pcs)
	(Kw)	(HP)						
QDX15-16-0.37TF	0.37	0.5	6	16	1"	10.7	370 x 190 x 165	1800
QDX15-25-0.55TF	0.55	0.75	8.5	26	1"	14.5	380 x 220 x 195	1350
QDX3-18-0.55TF	0.55	0.75	8	20	1.25"	14.5	380 x 220 x 195	1350
QDX10-12-0.55TF	0.55	0.75	14	15	1.5"	15	397 x 247 x 193	1300
QDX15-7-0.55TF	0.55	0.75	22	8	2"	15	405 x 243 x 192	1300
QDX15-32-0.75TF	0.75	1	7	32	1"	17	405 x 243 x 192	1150
QDX8-18-0.75TF	0.75	1	15	20	1.5"	17.5	405 x 243 x 192	1100
QDX10-16-0.75TF	0.75	1	20	20	2"	17.5	430 x 255 x 192	1100
QDX15-10-0.75TF	0.75	1	26	10	2.5"	17.5	430 x 255 x 192	1100
QDX26-6-0.75TF	0.75	1	32	9.5	3"	18	430 x 255 x 192	1100
QDX3-35-1.1TF	1.1	1.5	8	37	1"	23	530 x 260 x 270	770
QDX6-26-1.1TF	1.1	1.5	14	27	1.5"	23	530 x 260 x 270	770
QDX40-6-1.1TF	1.1	1.5	50	10	3"	24	530 x 260 x 270	750
QDX40-9-1.5TF	1.5	2	55	12	3"	26	530 x 260 x 270	750
QDX15-16-0.37S	0.37	0.5	6	18	1"	11.5	370 x 160 x 203	1700
QDX15-25-0.55S	0.55	0.75	8.5	26	1"	14	370 x 105 x 218	1400
QDX3-18-0.55S	0.55	0.75	8	20	1.25"	15	370 x 105 x 218	1400
QDX10-12-0.55S	0.55	0.75	14	15	1.5"	16	370 x 195 x 235	1250
QDX15-7-0.55S	0.55	0.75	22	8	2"	16.5	370 x 195 x 235	1200
QDX15-32-0.75S	0.75	1	7	32	1"	17	380 x 220 x 230	1150
QDX8-18-0.75S	0.75	1	15	20	1.5"	17.5	380 x 220 x 230	1100
QDX10-16-0.75S	0.75	1	20	20	2"	17.5	380 x 220 x 230	1100
QDX15-10-0.75S	0.75	1	26	10	2.5"	18	380 x 220 x 230	1100
QDX30-6-0.75S	0.75	1	32	9.5	3"	19.5	400 x 170 x 260	1000
QDX3-35-1.1S	1.1	1.5	8	37	1"	19.5	425 x 220 x 210	1000
QDX6-26-1.1S	1.1	1.5	14	27	1.5"	19.5	450 x 260 x 220	1000
QDX40-6-1.1S	1.1	1.5	50	10	3"	21.5	470 x 260 x 220	900
QDX40-9-1.5S	1.5	2	55	12	3"	23.5	490 x 280 x 220	850

SUBMERSIBLE PUMPS



FLOSPA-A SERIES

SUBMERSIBLE PUMPS

OPERATING LIMITS

- Max. ambient temperature +40°C
- Max. ambient temperature +60°C
- PH level from 6.5-8.5
- Maximum sand content is 0.1%
- Passage of suspended solids up to 0.2mm.
- Voltage fluctuation range: 0.9-1.1 times of the rated value
- Immersion depth from 0.5m-5m

MATERIAL

- Pump body: Cast iron
- Motor housing: Stainless steel
- Impeller: Aluminum
- Motor wire: Copper
- Mechanical seal: Ceramic&Graphite
- Shaft: 45Steel/stainless steel

MOTOR INFORMATION

- Two-pole induction motor
- Single phase/three phase, 50/60Hz (on demand)
- Thermal protector for single phase
- Insulation class: B
- Protection class: IP X8

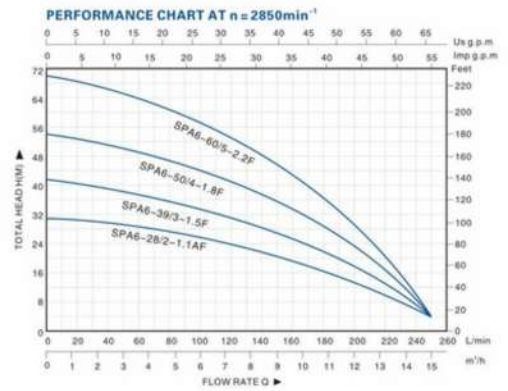

TECHNICAL DATA

Model	Power		Q. Max (L/min)	H. Max (m)	Inlet/Outlet (mm)	G.W. (kg)	Packing dimension (mm)	20GP (pcs)
	(Kw)	(HP)						
SPA6-28/2-1.1AF	1.1	1.5	250	30	50	23	535 x 185 x 260	850
SPA6-39/3-1.5AF	1.5	2	250	42	50	25	580 x 185 x 260	800
SPA6-50/4-1.8AF	1.8	2.5	250	55	50	28	620 x 185 x 260	700
SPA6-60/5-2.2AF	2.2	3	250	70	50	31.5	680 x 185 x 260	600

FLO V SERIES

SEWAGE SUBMERSIBLE PUMPS

OPERATING LIMITS

- Max. medium temperature +40°C
- Max. ambient temperature +40°C
- PH level from 4-10
- Maximum passage for suspended solids: 45
- Voltage fluctuation range: 0.9-1.1 times of the rated value
- Immersion depth from 0.5m-5m

MATERIAL

- Pump body: Cast iron
- Motor housing: Stainless steel
- Impeller: Aluminum
- Motor wire: Copper
- Mechanical seal: Ceramic&Graphite
- Shaft: 45#steel/stainless steel

MOTOR INFORMATION

- Two-pole induction motor
- Single phase/three phase, 50/60Hz (on demand)
- Thermal protector for single phase
- Insulation class: B
- Protection class: IP X8

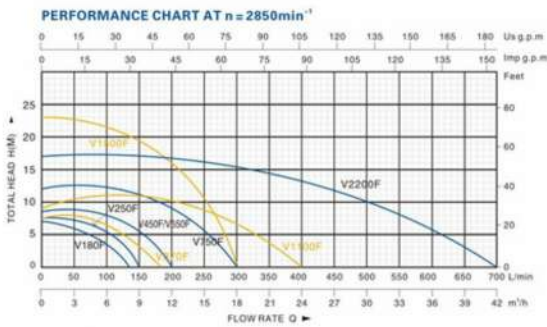

TECHNICAL DATA

Model	Power		Q.Max (L/min)	H.Max (m)	Inlet/Outlet (mm)	G.W. (kg)	Packing dimension (mm)	20GP (pcs)
	(Kw)	(HP)						
V180F	0.18	0.25	133	7	40 32 25	9.6	215 x 170 x 450	1700
V250F	0.25	0.35	150	7.5	40 32 25	10.5	215 x 170 x 450	1700
V370F	0.37	0.5	183	7.5	40 32 25	11	215 x 170 x 450	1700
V450F	0.45	0.6	200	8.5	40 50	16	260 x 197 x 455	1250
V550F	0.55	0.75	200	8.5	40 50	17.7	260 x 197 x 470	1100
V750F	0.75	1	300	12	40 50	19	260 x 197 x 475	1000
V1100F	1.1	1.5	400	9	40 50	20	300 x 250 x 545	700
V1500F	1.5	2	300	23	40 50	24	555 x 300 x 250	700
V2200F	2.2	3	700	17	75	33	573 x 336 x 225	600

FLO V-D SERIES

CUTTING SEWAGE SUBMERSIBLE PUMPS

OPERATING LIMITS

- Max. medium temperature +40°C
- Max. ambient temperature +40°C
- PH level from 4-10
- Maximum passage for suspended solids: 50
- Voltage fluctuation range: 0.9-1.1 times of the rated value
- Immersion depth from 0.5m-5m

MATERIAL

- Pump body: Cast iron
- Motor housing: Stainless steel
- Impeller: Cast iron
- Motor wire: Copper
- Mechanical seal: Ceramic&Graphite
- Shaft: 45#steel/stainless steel

MOTOR INFORMATION

- Two-pole induction motor
- Single phase/three phase, 50/60Hz (on demand)
- Thermal protector for single phase
- Insulation class: B
- Protection class: IP X8

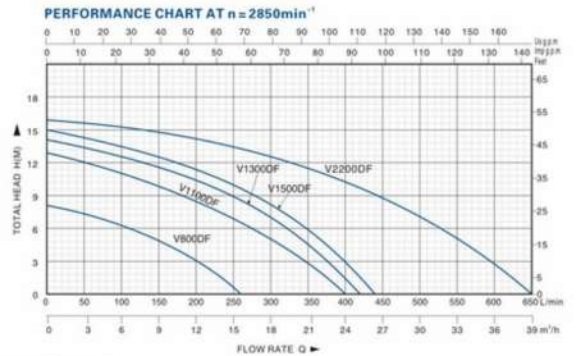

TECHNICAL DATA

Model	Power		Q.Max (L/min)	H.Max (m)	Inlet/Outlet (inch)	Vol./Fre. (V/Hz)	Cable (m)	G.W. (kg)	Packing dimension (mm)	20GP (pcs)
	(Kw)	(HP)								
V800DF	0.8	1.1	260	8	2"	220/50	8	19.7	260 x 200 x 495	1080
V1100DF	1.1	1.5	400	13	2"	220/50	8	22.8	270 x 215 x 526	910
V1300DF	1.3	1.7	420	14	2"	220/50	8	23.8	270 x 215 x 546	880
V1500DF	1.5	2	440	15	2"	220/50	8	25.3	570 x 220 x 270	830
V2200DF	2.2	3	650	16	3"	220/50	8	33	565 x 323 x 228	670

FLOSEWAGE SUBMERSIBLE PUMPS

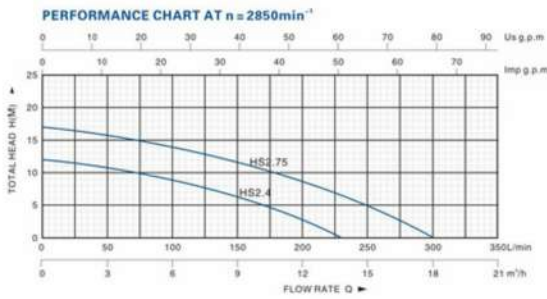

TECHNICAL DATA

Model	Power		Q. Max (L/min)	H. Max (m)	Inlet/Outlet (mm)	G.W. (kg)	Packing dimension (mm)	20GP (pcs)
	(Kw)	(HP)						
FLOHS2.4	0.55	0.75	230	12	50	13	250x195x355	1650
FLOHS2.75	0.75	1	300	17	50	16	250x195x390	1500

FLOWQD SERIES SEWAGE PUMPS

OPERATING LIMITS

- Max. medium temperature: +40°C
- Max. ambient temperature: +40°C
- PH level: from 4 - 10
- Maximum passage for suspended solids: 0-35
- Voltage fluctuation range: 0.9-1.1 times of the rated value
- Immersion depth: from 0.5m-5m

MATERIAL

- Pump body: Cast iron
- Motor housing: Cast iron or Aluminum
- Impeller: Cast iron
- Motor wire: Copper
- Mechanical seal: Ceramic/Graphite
- Shaft: 45steel/stainless steel

MOTOR INFORMATION

- Two-pole induction motor
- Single phase-three phase, 50/60Hz (on demand)
- Thermal protector for single phase
- Insulation class: B
- Protection class: IP X8

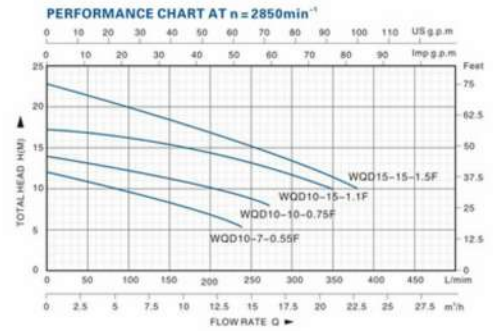

TECHNICAL DATA

Model	Power		Q. Max (m³/h)	H. Max (m)	Inlet/Outlet (inch)	N.W. (kg)	Packing dimension (mm)	20GP (pcs)
	(Kw)	(HP)						
WDD10-7-0.55F	0.55	0.75	10	7	2"	14	430 x 270 x 160	1400
WDD10-10-0.75F	0.75	1	10	10	2"	17	450 x 267 x 190	1200
WDD10-15-1.1F	1.1	1.5	10	15	2"	22	470 x 270 x 230	900
WDD15-15-1.5F	1.5	2	15	15	2"	23	480 x 260 x 270	800

FLOWQD SERIES

SEWAGE PUMPS

OPERATING LIMITS

- Max. medium temperature +40°C
- Max. ambient temperature +40°C
- PH level from 4-10
- Maximum passage for suspended solids: Ø35
- Voltage fluctuation range: 0.9-1.1 times of the rated value
- Immersion depth from 0.5m-5m

MATERIAL

- Pump body: Cast iron
- Motor housing: Cast iron
- Impeller: Cast iron
- Motor wire: Copper
- Mechanical seal: Ceramic&Graphite
- Shaft: 45steel/stainless steel

MOTOR INFORMATION

- Two-pole induction motor
- Single phase/three phase, 50/60Hz (on demand)
- Thermal protector for single phase
- Insulation class: B
- Protection class: IP X8



PERFORMANCE CHART AT $n = 2850 \text{min}^{-1}$

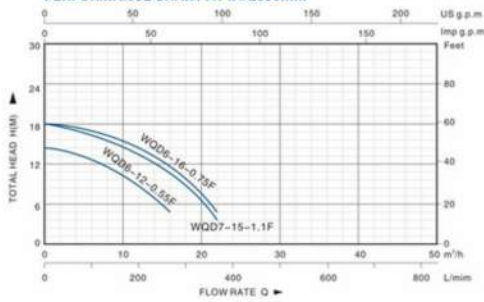

TECHNICAL DATA

Model	Power		Q.Max (m ³ /h)	H.Max (m)	Inlet/Outlet (inch)	N.W. (kg)	Packing dimension (mm)	20GP (pcs)
	(Kw)	(HP)						
WQD6-12-0.55F	0.55	0.75	6	12	1.5"	19	470 x 250 x 245	1000
WQD6-16-0.75F	0.75	1	18	19	1.5"	21	470 x 250 x 245	900
WQD7-15-1.1F	1.1	1.5	23	22	1.5"	28	540 x 240 x 280	700

FLOWQ SERIES

SEWAGE PUMP



TECHNICAL DATA

Model	Rated Flow (m ³ /h)	Rated Head (m)	Power (kW)	Voltage (V)	Speed (r/min)	Frequency (Hz)	Pipe Size (mm)
WQD6-6-0.55	6	6	0.55	220	3000	50	40/50
WQD10-7-0.55	10	7	0.55	220	3000	50	50
WQD6-16-0.75	6	16	0.75	220	3000	50	40
WQD10-10-0.75	10	10	0.75	220	3000	50	50
WQD20-12-1.1	20	12	1.1	220	3000	50	63
WQD10-15-1.5	10	15	1.5	220	3000	50	50
WQD15-10-1.5	15	10	1.5	220	3000	50	65
WQD15-15-1.5	15	15	1.5	220	3000	50	50
WQ9-22-2.2	9	22	2.2	380	3000	50	40
WQ15-15-2.2	15	15	2.2	380	3000	50	50
WQ25-10-2.2	25	10	2.2	380	3000	50	65
WQ15-30-3	15	30	3	380	3000	50	50
WQ25-15-3	25	15	3	380	3000	50	65
WQ35-10-3	35	10	3	380	3000	50	75
WQ15-32-4	15	32	4	380	3000	50	50
WQ25-25-4	25	25	4	380	3000	50	65
WQ40-15-4	40	15	4	380	3000	50	75

FLOWQ SERIES

SEWAGE PUMP

TECHNICAL DATA

Model	Rated Flow (m ³ /h)	Rated Head (m)	Power (kW)	Voltage (V)	Speed (r/min)	Frequency (Hz)	Pipe Size (mm)
WQ15-40-5.5	15	40	5.5	380	3000	50	50
WQ25-30-5.5	25	30	5.5	380	3000	50	65
WQ40-22-5.5	40	22	5.5	380	3000	50	75
WQ60-18-5.5	60	18	5.5	380	3000	50	100
WQ45-22-7.5	45	22	7.5	380	3000	50	75
WQ65-20-7.5	65	20	7.5	380	3000	50	100
WQ100-12-7.5	100	12	7.5	380	3000	50	150
WQ80-13-5.5	80	13	5.5	380	1450	50	80
WQ110-10-5.5	110	10	5.5	380	1450	50	100
WQ150-7-5.5	150	7	5.5	380	1450	50	150
WQ80-15-7.5	80	15	7.5	380	1450	50	80
WQ100-15-7.5	100	15	7.5	380	1450	50	100
WQ145-9-7.5	145	9	7.5	380	1450	50	150
WQ100-25-11	100	25	11	380	1450	50	100
WQ180-11-11	180	11	11	380	1450	50	150
WQ300-7-11	300	7	11	380	1450	50	200
WQ400-5-11	400	5	11	380	1450	50	200
WQ100-30-15	100	30	15	380	1450	50	100
WQ180-15-15	180	15	15	380	1450	50	150
WQ250-11-15	250	11	15	380	1450	50	200
WQ400-7-15	400	7	15	380	980	50	200
WQ100-35-18.5	100	35	18.5	380	1450	50	100
WQ180-20-18.5	180	20	18.5	380	1450	50	150
WQ200-15-18.5	200	15	18.5	380	1450	50	150
WQ150-26-18.5	150	26	18.5	380	1450	50	150
WQ250-15-18.5	250	15	18.5	380	1450	50	200
WQ350-10-18.5	350	10	18.5	380	1450	50	200
WQ600-5-18.5	600	5	18.5	380	980	50	250
WQ100-40-22	100	40	22	380	1450	50	100
WQ200-22-22	200	22	22	380	1450	50	150
WQ250-18-22	250	18	22	380	1450	50	200
WQ400-10-22	400	10	22	380	1450	50	200
WQ500-7-22	500	7	22	380	980	50	250
WQ180-30-30	180	30	30	380	1450	50	150
WQ250-22-30	250	22	30	380	1450	50	200
WQ600-9-30	600	9	30	380	1450	50	250
WQ850-7-30	850	7	30	380	980	50	300
WQ180-37-37	180	37	37	380	1450	50	150
WQ350-25-37	350	25	37	380	1450	50	200
WQ700-11-37	700	11	37	380	1450	50	250
WQ800-12-37	800	12	37	380	1450	50	250
WQ800-10-37	800	10	37	380	980	50	300
WQ180-45-45	180	45	45	380	1450	50	150
WQ400-30-45	400	30	45	380	1450	50	200
WQ600-15-45	600	15	45	380	1450	50	250
WQ800-12-45	800	12	45	380	980	50	300
WQ500-15-45	500	15	45	380	980	50	300
WQ1200-8-45	1200	8	45	380	980	50	350
WQ1300-7-45	1300	7	45	380	980	50	350
WQ200-50-55	200	50	55	380	1450	50	150
WQ300-40-55	300	40	55	380	1450	50	200
WQ400-30-55	400	30	55	380	1450	50	200

FLOGSP SERIES

GARDEN SUBMERSIBLE PUMPS

OPERATING LIMITS

- Max. medium temperature: +40°C
- Max. ambient temperature: +40°C
- Max. grain size: 5/35mm
- Voltage fluctuation range: 0.9-1.1 times of the rated value (inversion depth from 0.5m-5m)

MATERIAL

- Pump body: PP
- Motor housing: PP
- Impeller: PA
- Motor wire: Copper
- Mechanical seal: Ceramic/Graphite
- Shaft: 430steel/stainless steel

MOTOR INFORMATION

- Two-pole induction motor
- Single phase-three phase, 50/60Hz (on demand)
- Thermal protector for single phase
- Insulation class: B
- Protection class: IP X8



TECHNICAL DATA

Model	Power		Q. Max (L/h)	H. Max (m)	Outlet (inch)	G. W. (kg)	Packing dimension		20GP (pcs)
	(w)	(HP)					(mm)	pcs/ctn	
GSP250C	250	0.33	5500	6	1.5"	17	460 × 340 × 330	4	2200
GSP400C	400	0.53	7300	7.5	1.5"	18	460 × 340 × 330	4	2200
GSP550C	550	0.75	11500	8.5	1.5"	19	460 × 340 × 330	4	2200
GSP750C	750	1	13000	9.5	1.5"	21	460 × 340 × 360	4	2040
GSP900C	900	1.2	15000	10	1.5"	22	460 × 340 × 360	4	2040
GSP400D	400	0.53	7500	5	1.5"	17.5	460 × 340 × 360	4	2040
GSP550D	550	0.75	10500	7	1.5"	19	460 × 340 × 360	4	2040
GSP750D	750	1	12500	8	1.5"	21	460 × 340 × 385	4	1900
GSP900D	900	1.2	14000	8.5	1.5"	22	460 × 340 × 385	4	1900
GSP1000D	1000	1.5	15000	9	1.5"	23	460 × 340 × 385	4	1900

FLOGSP SERIES

GARDEN SUBMERSIBLE PUMPS

OPERATING LIMITS

- Max. medium temperature: +40°C
- Max. ambient temperature: +40°C
- PH level from 4-10
- Maximum passage for suspended solids: ϕ 3/25mm
- Voltage fluctuation range: 0.9-1.1 times of the rated value
- Immersion depth from 0.5m-5m

MATERIAL

- Pump body: Stainless Steel
- Motor housing: Stainless Steel
- Impeller: PA
- Motor wire: Copper
- Mechanical seal: Ceramic&Graphite
- Shaft: 45steel/stainless steel

MOTOR INFORMATION

- Two-pole induction motor
- Single phase/three phase, 50/60Hz (on demand)
- Thermal protector for single phase
- Insulation class: B
- Protection class: IP X8

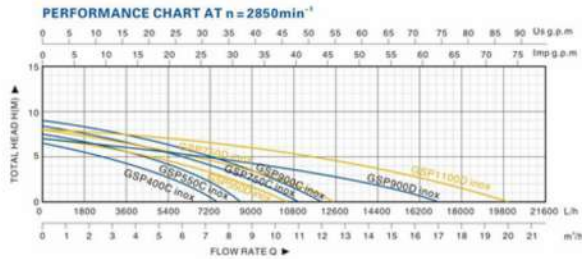

TECHNICAL DATA

Model	Power		Q. Rated (l/h)	H. Rated (m)	Inlet/Outlet (inch)	G. W. (kg)	Packing dimension		20GP (pcs)
	(Kw)	(HP)					(mm)	(pcs/ctn)	
GSP400C inox	0.4	0.53	7500	6.5	1.5"	20	460 x 340 x 330	4	2240
GSP550C inox	0.55	0.75	8500	7.5	1.5"	22	460 x 340 x 330	4	2240
GSP790C inox	0.75	1	11000	8.5	1.5"	24	460 x 340 x 330	4	2240
GSP900C inox	0.9	1.2	12000	9	1.5"	25.5	460 x 340 x 360	4	2060
GSP950D inox	0.55	0.75	10500	7	1.5"	22.5	460 x 380 x 360	4	1840
GSP790D inox	0.75	1	12500	8	1.5"	24.5	460 x 380 x 360	4	1840
GSP900D inox	0.9	1.2	17000	7	1.5"	25.5	460 x 380 x 385	4	1720
GSP1100D inox	1.1	1.5	20000	8	1.5"	26.5	460 x 380 x 385	4	1720

FLOGP/AUGP SERIES

GARDEN JET PUMP

OPERATING LIMITS

- Max. medium temperature: +40°C
- Max. ambient temperature: +40°C
- PH level from 4-10
- Voltage fluctuation range: 0.9-1.1 times of the rated value

MATERIAL

- Pump body: PP
- Motor housing: Aluminum
- Impeller: PPO
- Motor wire: Copper
- Mechanical seal: Ceramic&Graphite
- Shaft: 45steel/stainless steel

MOTOR INFORMATION

- Two-pole induction motor
- Single phase/three phase, 50/60Hz (on demand)
- Thermal protector for single phase
- Insulation class: B
- Protection class: IP X8

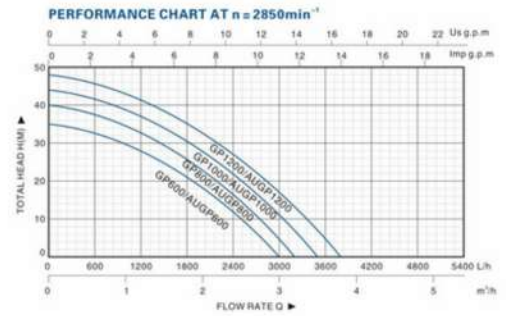

TECHNICAL DATA

Model	Power		Q. Rated (L/h)	H. Rated (m)	Outlet (inch)	G. W. (kg)	Packing dimension (mm)	20GP (pcs)
	(Kw)	(HP)						
GP600	0.6	0.8	3000	35	1"	6.3	365 x 220 x 200	1800
GP800	0.8	1.1	3200	40	1"	7	365 x 220 x 200	1800
GP1000	0.1	1.3	3500	44	1"	7.2	365 x 220 x 200	1800
GP1200	1.2	1.6	3800	48	1"	7.5	365 x 220 x 200	1800
AUGP600	0.6	0.8	3000	35	1"	10.5	440 x 280 x 530	400
AUGP800	0.8	1.1	3200	40	1"	10.8	440 x 280 x 530	400
AUGP1000	0.1	1.3	3500	44	1"	11.1	440 x 280 x 530	400
AUGP1200	1.2	1.6	3800	48	1"	11.4	440 x 280 x 530	400

3SDM SERIES

DEEP WELL SUBMERSIBLE PUMP

APPLICATIONS

- For water supply from wells or reservoirs.
- For domestic use, for civil and industrial applications.
- For garden use and irrigation.

OPERATING CONDITIONS

- Maximum fluid temperature up to +35°C.
- Maximum sand content 0.25%.
- Maximum immersion 50m.
- Maximum well diameter 2"

MOTOR AND PUMP

- Reversible motor or full obtained screen motor
- Three-phase 300V-410V/50Hz
- Single-phase 210V-240V/50Hz
- Equip with start control box or digital auto-control box
- Pumps are designed by using stainless
- NEMA dimension standards

MODEL SPECIFICATION

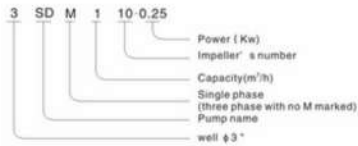

TECHNICAL DATA

Model	DN	Dimensions (mm)		Weight(kg)
		L1	L	
1-200V/240V				
3SDM1/10-0.25	1"	427	747	7.75
3SDM1/15-0.37	1"	555	900	9.35
3SDM1/22-0.55	1"	760	1140	11
3SDM1/30-0.75	1"	970	1395	13.3
3SDM1/40-1.1	1"	1240	1705	15.7
3SDM2/8-0.25	1 7/16"	400	720	7.1
3SDM2/11-0.37	1 7/16"	483	828	8.2
3SDM2/17-0.55	1 7/16"	674	1054	9.8
3SDM2/24-0.75	1 7/16"	891	1316	11.9
3SDM2/33-1.1	1 7/16"	1139	1804	14.2



3SDM SERIES

DEEP WELL SUBMERSIBLE PUMP

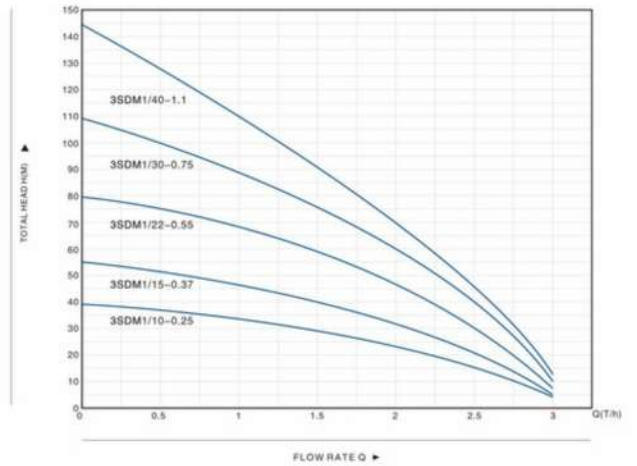

TECHNICAL DATA

Model	P2		Delivery											
	Kw	HP	Q		n ~ 2850r/min									
1-220V/240V			m ³ /h	L/min	0	0.5	1	1.5	1.8	2	2.5	3		
3SDM1/10-0.25	0.25	0.33			38	36	33	28	23	20	10	4		
3SDM1/15-0.37	0.37	0.5			55	54	50	40	34	29	14	5		
3SDM1/22-0.55	0.55	0.75			79	78	72	58	50	42	20	7		
3SDM1/30-0.75	0.75	1			108	105	93	76	64	57	27	10		
3SDM1/40-1.1	1.1	1.5			144	132	120	91	76	60	25	13		
3SDM2/8-0.25	0.25	0.33		H(m)	28	27	26	25	23	22	17	11		
3SDM2/11-0.37	0.37	0.5			39	37	36	34	32	30	24	15		
3SDM2/17-0.55	0.55	0.75			60	58	56	52	49	46	37	23		
3SDM2/24-0.75	0.75	1			85	82	79	74	70	65	52	33		
3SDM2/33-1.1	1.1	1.5			110	107	101	95	90	85	67	42		

3.5SDM SERIES

DEEP WELL SUBMERSIBLE PUMP

APPLICATIONS

- For water supply from wells or reservoirs.
- For domestic use, for civil and industrial applications.
- For garden use and irrigation.

OPERATING CONDITIONS

- Maximum fluid temperature up to +25°C.
- Maximum sand content 0.25%.
- Maximum immersion 10m.
- Maximum well diameter 2"

MOTOR AND PUMP

- Reversible motor or full obtained screen motor
- Three-phase 300V-410V/50Hz
- Single-phase 215V-240V/50Hz
- Equip with start control box or digital auto-control box
- Pumps are designed by casting stressed
- NEMA dimension standards

MODEL SPECIFICATION

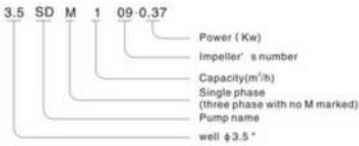

TECHNICAL DATA

Model	DN	Dimensions (mm)		Weight(kg)
		L1	L	
1-200V/240V				
3.5SDM1/9-0.37	1 7/8"	410	742	10
3.5SDM1/12-0.55	1 7/8"	538	895	11
3.5SDM1/14-0.55	1 7/8"	563	920	12
3.5SDM1/16-0.75	1 7/8"	657	1039	13
3.5SDM1/22-1.1	1 7/8"	789	1188	14
3.5SDM1/26-1.5	1 7/8"	886	1323	16
3.5SDM2/5-0.25	1 7/8"	327	644	8
3.5SDM2/7-0.37	1 7/8"	385	717	8.7
3.5SDM2/11-0.55	1 7/8"	541	898	10.5
3.5SDM2/16-0.75	1 7/8"	681	1063	11.9
3.5SDM2/19-1.1	1 7/8"	783	1185	13.6
3.5SDM2/21-1.5	1 7/8"	866	1303	15



3.5SDM SERIES

DEEP WELL SUBMERSIBLE PUMP

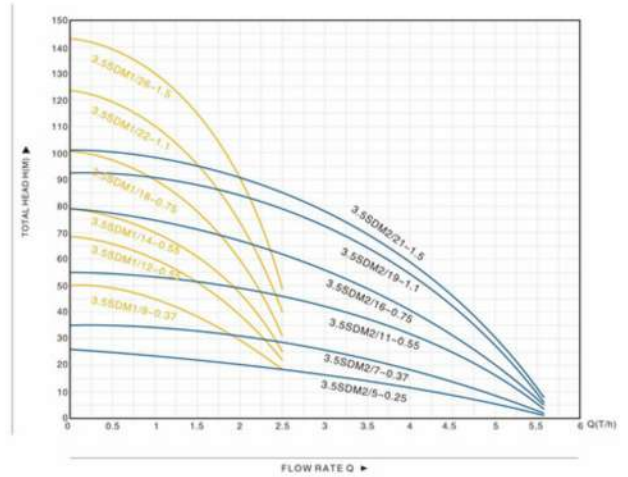

TECHNICAL DATA

Model	P2		Delivery											n ~ 2850r/min
	Kw	HP	Q	m ³ /h										
1-220V/240V				0	0.5	1	1.5	2	2.5	3	3.5	4	4.5	5.6
				0	8	17	25	33	42	50	58	66	75	93
3.5SDM1/9-0.37	0.37	0.5	H(m)	50	49	45	38	29	17					
3.5SDM1/12-0.55	0.55	0.75		67	65	60	50	38	22					
3.5SDM1/14-0.55	0.55	0.75		78	76	70	59	45	25					
3.5SDM1/16-0.75	0.75	1		101	98	90	76	58	32					
3.5SDM1/22-1.1	1.1	1.5		123	120	110	92	70	40					
3.5SDM1/26-1.5	1.5	2		143	138	130	109	83	47					
3.5SDM2/5-0.25	0.25	0.33		26	25	25	24	23	22	20	17	15	11	2
3.5SDM2/7-0.37	0.37	0.5		35	34	33	32	30	28	26	23	18	14	3
3.5SDM2/11-0.55	0.55	0.75		55	54	53	52	49	46	42	38	32	25	4
3.5SDM2/16-0.75	0.75	1		78	76	75	71	66	62	55	48	39	30	5
3.5SDM2/19-1.1	1.1	1.5		93	92	91	89	84	79	71	63	53	42	6
3.5SDM2/21-1.5	1.5	2		102	101	100	96	91	85	77	68	56	43	7

4SDM 2 SERIES

DEEP WELL SUBMERSIBLE PUMP

APPLICATIONS

- For water supply from wells or reservoirs.
- For domestic use, for civil and industrial applications.
- For garden use and irrigation.

OPERATING CONDITIONS

- Water temperature up to 35°C
- Minimum internal diameter of well 100mm.
- Maximum immersion depth 100m.

MOTOR

- 1 Full stator screen motor
- 2 Rewind able motor
- Three-phase 380V-415V/50Hz
- Single-phase 220V-240V/50Hz
- Control box with capacitor, on request.

SPECIAL FEATURES ON REQUEST

- Other voltages.
- Frequency 50/60Hz.
- Other mechanical seal.
- The length of cable over than 50m.
- Cable gland with cable fasteners.

MODEL SPECIFICATION

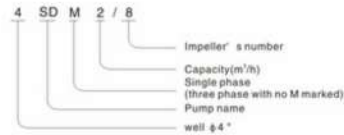

TECHNICAL DATA

Model	DN	Dimensions (mm)					Weight(kg)	
		L1	L(S)	L(T)	G(S)	G(T)		
1-200V/240V	2-380V/415V							
4SDM2/8	4SD2/8	1 1/4" / 1 1/2"	422	734	719	11	10	
4SDM2/11	4SD2/11	1 1/4" / 1 1/2"	497	824	809	12	11	
4SDM2/14	4SD2/14	1 1/4" / 1 1/2"	571	918	898	14	13	
4SDM2/20	4SD2/20	1 1/4" / 1 1/2"	752	1139	1099	17	15	
4SDM2/26	4SD2/26	1 1/4" / 1 1/2"	900	1347	1287	20	18	
4SDM2/32	4SD2/32	1 1/4" / 1 1/2"	1067	1603	1514	26	22	
4SDM2/36	4SD2/36	1 1/4" / 1 1/2"	1166	1702	1613	27	23	
-	4SD2/44	1 1/4" / 1 1/2"	1396	-	1873	-	27	
-	4SD2/52	1 1/4" / 1 1/2"	1595	-	2146	-	31	
-	4SD2/60	1 1/4" / 1 1/2"	1793	-	2344	-	33	



4SDM 2 SERIES

DEEP WELL SUBMERSIBLE PUMP

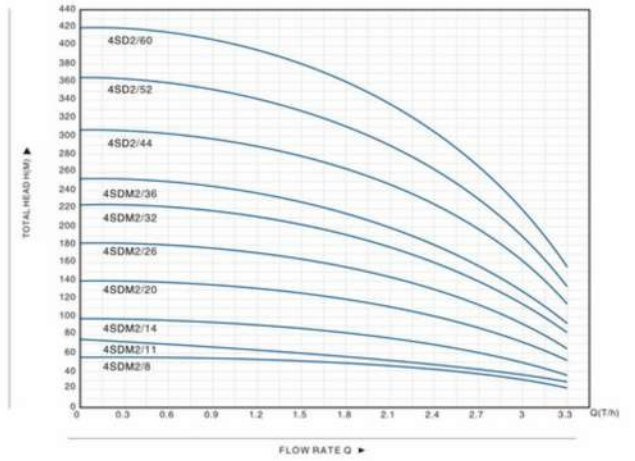

TECHNICAL DATA

Model	P2	Delivery															
		Kw		HP		n ~ 2850/min											
1-220V/240V	3-380V/415V	Q	m ³ /h	L/min	0	0.3	0.6	0.9	1.2	1.5	1.8	2.1	2.4	2.7	3	3.3	
4SDM2/8	4SD2/8	0.37	0.5		56	56	55	54	53	51	48	44	39	33	27	21	
4SDM2/11	4SD2/11	0.55	0.75		77	76	76	75	73	70	66	61	54	46	37	28	
4SDM2/14	4SD2/14	0.75	1		98	97	97	95	92	89	84	77	69	58	47	36	
4SDM2/20	4SD2/20	1.1	1.5		140	139	138	136	132	127	120	111	98	83	67	52	
4SDM2/26	4SD2/26	1.5	2		182	181	179	176	172	165	156	144	127	108	86	67	
4SDM2/32	4SD2/32	2.2	3		224	222	221	217	211	203	191	177	157	133	108	83	
4SDM2/36	4SD2/36	2.2	3		252	250	248	244	238	228	215	199	176	149	121	93	
-	4SD2/44	3	4		308	306	304	298	290	279	263	243	216	183	148	114	
-	4SD2/52	4	5.5		364	361	359	353	343	329	311	288	255	216	175	134	
-	4SD2/60	4	5.5		420	417	414	407	396	380	359	332	294	249	202	155	

4SDM 3 SERIES

DEEP WELL SUBMERSIBLE PUMP

APPLICATIONS

- For water supply from wells or reservoirs.
- For domestic use, for civil and industrial applications.
- For garden use and irrigation.

OPERATING CONDITIONS

- Water temperature up to 35°C.
- Minimum internal diameter of well 100mm.
- Maximum immersion depth 100m.

MOTOR

- 1 Full obfuscated screen motor
- 2 Rewindable motor
- Three phase 380V-415V/50Hz
- Single phase 230V-240V/50Hz
- Control box with capacitor, on request.

SPECIAL FEATURES ON REQUEST

- Other voltages.
- Frequency 50-60Hz.
- Other mechanical seal.
- The length of cable over than 50m.
- Cable gland with cable fasteners.

MODEL SPECIFICATION

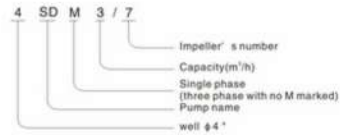

TECHNICAL DATA

Model	DN	Dimensions (mm)				Weight(kg)	
		L1	L(S)	L(T)	G(S)	G(T)	
1-200V/240V	3-380V/415V						
4SDM3/7	4SD3/7	1 1/4" / 1 1/2"	412	724	709	11	10
4SDM3/9	4SD3/9	1 1/4" / 1 1/2"	466	793	778	12	11
4SDM3/12	4SD3/12	1 1/4" / 1 1/2"	547	894	874	13	12
4SDM3/17	4SD3/17	1 1/4" / 1 1/2"	681	1068	1028	16	14
4SDM3/22	4SD3/22	1 1/4" / 1 1/2"	847	1294	1234	20	17
4SDM3/26	4SD3/26	1 1/4" / 1 1/2"	955	1491	1402	25	21
4SDM3/30	4SD3/30	1 1/4" / 1 1/2"	1083	1619	1530	26	22
-	4SD3/36	1 1/4" / 1 1/2"	1244	-	1721	-	25
-	4SD3/42	1 1/4" / 1 1/2"	1437	-	1988	-	30
-	4SD3/48	1 1/4" / 1 1/2"	1598	-	2149	-	31
-	4SD3/54	1 1/4" / 1 1/2"	1760	-	2381	-	35
-	4SD3/60	1 1/4" / 1 1/2"	1921	-	2542	-	36



4SDM 3 SERIES

DEEP WELL SUBMERSIBLE PUMP

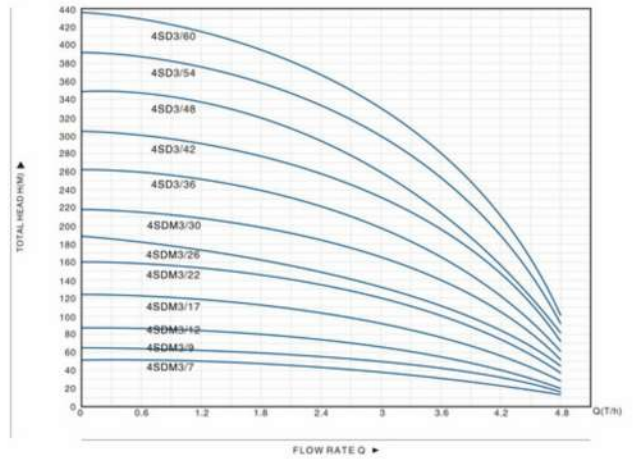

TECHNICAL DATA

Model	P2		Delivery n ~ 2850r/min												
	1-220V/240V	3-380V/415V	Kw	HP	Q	m ³ /h	0	0.6	1.2	1.8	2.4	3	3.6	4.2	4.8
4SDM3/7	4SD3/7	0.37	0.5			51	50	48	46	43	38	31	22	12	
4SDM3/9	4SD3/9	0.55	0.75			65	64	62	59	55	49	39	28	15	
4SDM3/12	4SD3/12	0.75	1			87	86	83	79	74	65	53	38	20	
4SDM3/17	4SD3/17	1.1	1.5			124	121	118	112	104	92	75	54	29	
4SDM3/22	4SD3/22	1.5	2			160	157	152	145	135	119	96	70	37	
4SDM3/26	4SD3/26	2.2	3			189	185	180	171	159	141	114	82	44	
4SDM3/30	4SD3/30	2.2	3		H(m)	218	214	208	198	184	163	132	95	51	
-	4SD3/36	3	4			262	257	249	237	221	195	158	114	61	
-	4SD3/42	4	5.5			305	300	291	277	258	228	184	133	71	
-	4SD3/48	4	5.5			349	342	332	316	294	260	210	152	81	
-	4SD3/54	5.5	7.5			392	385	374	356	331	293	237	171	91	
-	4SD3/60	5.5	7.5			436	428	415	395	368	325	263	190	101	

4SDM 4 SERIES

DEEP WELL SUBMERSIBLE PUMP

APPLICATIONS

- For water supply from wells or reservoirs.
- For domestic use, for civil and industrial applications.
- For garden use and irrigation.

OPERATING CONDITIONS

- Water temperature up to 35°C
- Minimum internal diameter of well 100mm
- Maximum immersion depth 100m

MOTOR

- 1 Full obfuscated screen motor
- 2 Rewindable motor
- Three phase 380V-415V/50Hz
- Single phase 230V-240V/50Hz
- Control box with capacitor, on request

SPECIAL FEATURES ON REQUEST

- Other voltages
- Frequency 50-60Hz
- Other mechanical seal
- The length of cable over than 50m
- Cable gland with cable fasteners

MODEL SPECIFICATION

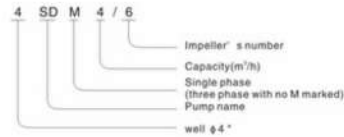

TECHNICAL DATA

Model	DN	Dimensions(mm)				Weight(kg)	
		L1	L(S)	L(T)	G(S)	G(T)	
4SDM4/6	4SD4/6	1 1/4" / 1 1/2" / 2"	397	709	694	11	10
4SDM4/8	4SD4/8	1 1/4" / 1 1/2" / 2"	454	781	766	12	11
4SDM4/10	4SD4/10	1 1/4" / 1 1/2" / 2"	512	859	839	13	12
4SDM4/14	4SD4/14	1 1/4" / 1 1/2" / 2"	627	1014	974	16	14
4SDM4/18	4SD4/18	1 1/4" / 1 1/2" / 2"	742	1189	1129	19	17
4SDM4/22	4SD4/22	1 1/4" / 1 1/2" / 2"	889	1425	1336	25	20
4SDM4/25	4SD4/25	1 1/4" / 1 1/2" / 2"	976	1512	1423	25	21
-	4SD4/32	1 1/4" / 1 1/2" / 2"	1197	-	1674	-	25
-	4SD4/40	1 1/4" / 1 1/2" / 2"	1459	-	2010	-	30
-	4SD4/48	1 1/4" / 1 1/2" / 2"	1689	-	2310	-	35
-	4SD4/52	1 1/4" / 1 1/2" / 2"	1805	-	2426	-	36



4SDM 4 SERIES

DEEP WELL SUBMERSIBLE PUMP

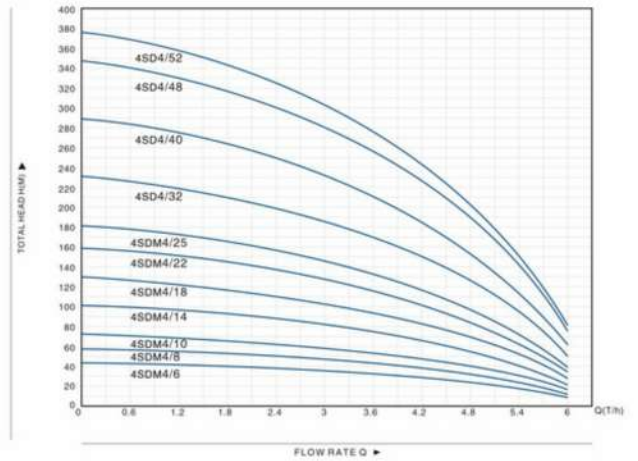

TECHNICAL DATA

Model	P2	Kw	HP	Q	Delivery n ~ 2850r/min										
					m ³ /h L/min										
1- 220V/240V	3- 380V/415V				0	0.6	1.2	1.8	2.4	3	3.6	4.2	4.8	5.4	6
4SDM4/6	4SD4/6	0.37	0.5		43	42	40	39	37	35	32	27	22	16	9
4SDM4/8	4SD4/8	0.55	0.75		58	56	54	52	50	47	42	36	29	21	12
4SDM4/10	4SD4/10	0.75	1		72	69	67	65	62	58	53	46	37	27	16
4SDM4/14	4SD4/14	1.1	1.5		101	97	94	91	87	82	74	64	51	37	22
4SDM4/18	4SD4/18	1.5	2		130	125	121	117	112	105	95	82	66	48	28
4SDM4/22	4SD4/22	2.2	3		159	153	148	143	137	128	116	100	81	59	34
4SDM4/25	4SD4/25	2.2	3		181	174	168	162	156	146	132	114	92	67	39
-	4SD4/32	3	4		231	222	215	208	199	186	169	146	118	86	50
-	4SD4/40	4	5.5		289	278	268	260	249	233	211	182	147	107	62
-	4SD4/48	5.5	7.5		347	333	322	312	299	280	253	219	176	128	75
-	4SD4/52	5.5	7.5		376	361	349	338	324	303	274	237	191	139	81

4SDM 6 SERIES

DEEP WELL SUBMERSIBLE PUMP

APPLICATIONS

- For water supply from wells or reservoirs.
- For domestic use, for civil and industrial applications.
- For garden use and irrigation.

OPERATING CONDITIONS

- Water temperature up to 35°C
- Minimum internal diameter of well 100mm
- Maximum immersion depth 100m

MOTOR

- 1 Full obtained screen motor
- 2 Rewind able motor
- Three phase 380V-415V/50Hz
- Single phase 230V-240V/50Hz
- Control box with capacitor, on request

SPECIAL FEATURES ON REQUEST

- Other voltages
- Frequency 50-60Hz
- Other mechanical seal
- The length of cable over than 50m
- Cable gland with cable fasteners

MODEL SPECIFICATION

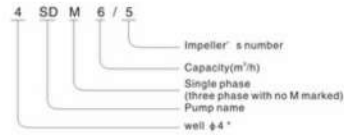

TECHNICAL DATA

Model	DN	Dimensions(mm)				Weight(kg)	
		L1	L(S)	L(T)	G(S)	G(T)	
1-200V/240V	3-380V/415V						
4SDM6/5	4SD6/5	1 1/4" / 1 1/2" / 2"	397	709	694	11	10
4SDM6/7	4SD6/7	1 1/4" / 1 1/2" / 2"	458	785	770	12	11
4SDM6/9	4SD6/9	1 1/4" / 1 1/2" / 2"	519	866	846	13	12
4SDM6/12	4SD6/12	1 1/4" / 1 1/2" / 2"	611	998	958	16	14
4SDM6/15	4SD6/15	1 1/4" / 1 1/2" / 2"	703	1150	1090	19	17
4SDM6/18	4SD6/18	1 1/4" / 1 1/2" / 2"	795	1331	1242	24	20
4SDM6/21	4SD6/21	1 1/4" / 1 1/2" / 2"	918	1454	1365	25	21
-	4SD6/25	1 1/4" / 1 1/2" / 2"	1041	-	1518	-	24
-	4SD6/30	1 1/4" / 1 1/2" / 2"	1194	-	1745	-	28
-	4SD6/35	1 1/4" / 1 1/2" / 2"	1347	-	1968	-	32
-	4SD6/41	1 1/4" / 1 1/2" / 2"	1562	-	2183	-	34
-	4SD6/46	1 1/4" / 1 1/2" / 2"	1715	-	2426	-	39



4SDM 6 SERIES

DEEP WELL SUBMERSIBLE PUMP

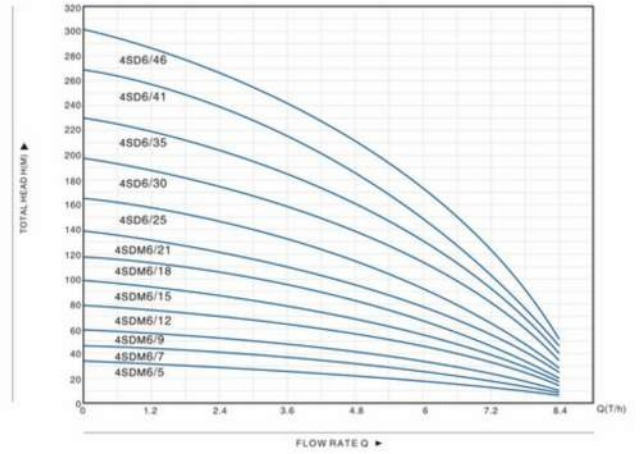

TECHNICAL DATA

Model	P2	Kw	HP	Q	Delivery n ~ 2850r/min															
					m ³ /h	L/min	0	1.2	2.4	3.6	4.8	6	7.2	8.4						
1-220V/240V	3-380V/415V																			
4SDM6/5	4SD6/5	0.37	0.5			33	31	28	26	23	18	12	6							
4SDM6/7	4SD6/7	0.55	0.75			46	43	40	37	33	26	17	8							
4SDM6/9	4SD6/9	0.75	1			59	56	51	47	42	33	22	10							
4SDM6/12	4SD6/12	1.1	1.5			79	74	68	63	56	44	30	14							
4SDM6/15	4SD6/15	1.5	2			98	93	85	79	70	55	37	17							
4SDM6/18	4SD6/18	2.2	3			118	112	103	95	85	67	45	20							
4SDM6/21	4SD6/21	2.2	3			138	130	120	110	99	78	52	24							
-	4SD6/25	3	4			164	155	142	132	117	92	62	28							
-	4SD6/30	4	5.5			197	188	171	158	141	111	75	34							
-	4SD6/35	4	5.5			230	217	199	184	164	129	87	40							
-	4SD6/41	5.5	7.5			269	254	234	216	193	152	103	46							
-	4SD6/46	5.5	7.5			302	285	262	242	216	170	115	52							

4SDM 8 SERIES

DEEP WELL SUBMERSIBLE PUMP

APPLICATIONS

- For water supply from wells or reservoirs.
- For domestic use, for civil and industrial applications.
- For garden use and irrigation.

OPERATING CONDITIONS

- Water temperature up to 35°C
- Minimum internal diameter of well 100mm
- Maximum immersion depth 100m

MOTOR

- 1 Full enclosed screen motor
- 2 Rewindable motor
- Three phase 380V-415V/50Hz
- Single phase 230V-240V/50Hz
- Control box with capacitor, on request

SPECIAL FEATURES ON REQUEST

- Other voltages
- Frequency 50-60Hz
- Other mechanical seal
- The length of cable over than 50m
- Cable gland with cable fasteners

MODEL SPECIFICATION

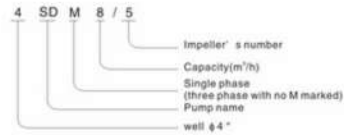

TECHNICAL DATA

Model	DN	Dimensions(mm)					Weight(kg)	
		L1	L(S)	L(T)	G(S)	G(T)		
1- 200V/240V	3- 380V/415V							
4SDM8/5	4SD8/5	1 1/4" / 1 1/2" / 2"	434	761	746	12	11	
4SDM8/7	4SD8/7	1 1/4" / 1 1/2" / 2"	510	857	837	13	12	
4SDM8/9	4SD8/9	1 1/4" / 1 1/2" / 2"	586	973	933	16	14	
4SDM8/12	4SD8/12	1 1/4" / 1 1/2" / 2"	700	1147	1087	19	17	
4SDM8/15	4SD8/15	1 1/4" / 1 1/2" / 2"	814	1350	1261	24	20	
4SDM8/17	4SD8/17	1 1/4" / 1 1/2" / 2"	890	1426	1337	25	20	
-	4SD8/21	1 1/4" / 1 1/2" / 2"	1074	-	1551	-	24	
-	4SD8/26	1 1/4" / 1 1/2" / 2"	1264	-	1815	-	29	
-	4SD8/30	1 1/4" / 1 1/2" / 2"	1416	-	1967	-	30	
-	4SD8/36	1 1/4" / 1 1/2" / 2"	1644	-	2265	-	34	
-	4SD8/40	1 1/4" / 1 1/2" / 2"	1827	-	2448	-	36	



4SDM 8 SERIES

DEEP WELL SUBMERSIBLE PUMP

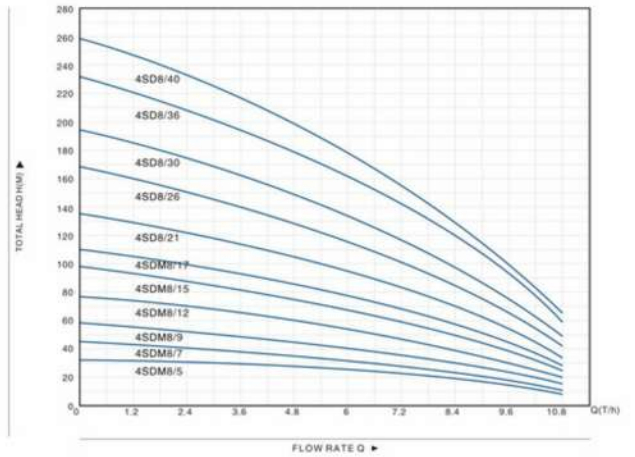

TECHNICAL DATA

Model	P2	Delivery														
		n ~ 2850r/min		Q												
1- 220V/240V	3- 380V/415V	Kw	HP	Q	m ³ /h	L/min	0	1.2	2.4	3.6	4.8	6	7.2	8.4	9.6	10.8
4SDM8/5	4SD8/5	0.55	0.75	H(m)	32	30	28	26	28	23	21	18	13	8		
4SDM8/7	4SD8/7	0.75	1		45	42	39	37	35	33	30	25	18	11		
4SDM8/9	4SD8/9	1.1	1.5		58	54	51	47	45	42	38	32	24	15		
4SDM8/12	4SD8/12	1.5	2		77	72	68	63	60	56	51	43	32	20		
4SDM8/15	4SD8/15	2.2	3		97	90	84	79	75	70	63	53	39	24		
4SDM8/17	4SD8/17	2.2	3		110	102	96	90	85	79	72	60	45	28		
-	4SD8/21	3	4		135	127	118	111	104	98	89	75	55	34		
-	4SD8/26	4	5.5		168	157	146	137	129	122	110	92	68	42		
-	4SD8/30	4	5.5		194	181	169	158	149	140	127	107	79	49		
-	4SD8/36	5.5	7.5		232	217	203	190	179	168	152	128	95	59		
-	4SD8/40	5.5	7.5		258	241	225	211	199	187	169	142	105	65		

4SDM 10 SERIES

DEEP WELL SUBMERSIBLE PUMP

APPLICATIONS

- For water supply from wells or reservoirs.
- For domestic use, for civil and industrial applications.
- For garden use and irrigation.

OPERATING CONDITIONS

- Water temperature up to 35°C
- Minimum internal diameter of well 100mm
- Maximum immersion depth 100m

MOTOR

- 1 Full obstructed screen motor
- 2 Rewind able motor
- Three phase 380V, 415V/50Hz
- Single phase 230V, 240V/50Hz
- Control box with capacitor, on request

SPECIAL FEATURES ON REQUEST

- Other voltages
- Frequency 50/60Hz
- Other mechanical seal
- The length of cable over than 50m
- Cable gland with cable fasteners

MODEL SPECIFICATION

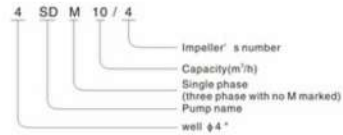

TECHNICAL DATA

Model	DN	Dimensions(mm)				Weight(kg)	
		L1	L(S)	L(T)	G(S)	G(T)	
1- 200V/240V	3- 380V/415V						
4SDM10/4	4SD10/4	1 1/4" / 1 1/2" / 2"	396	723	708	11	11
4SDM10/6	4SD10/6	1 1/4" / 1 1/2" / 2"	472	819	799	13	12
4SDM10/8	4SD10/8	1 1/4" / 1 1/2" / 2"	548	935	895	16	14
4SDM10/10	4SD10/10	1 1/4" / 1 1/2" / 2"	624	1071	1001	19	16
4SDM10/12	4SD10/12	1 1/4" / 1 1/2" / 2"	700	1236	1137	24	19
4SDM10/14	4SD10/14	1 1/4" / 1 1/2" / 2"	776	1312	1213	24	20
-	4SD10/17	1 1/4" / 1 1/2" / 2"	890	-	1367	-	23
-	4SD10/21	1 1/4" / 1 1/2" / 2"	1074	-	1625	-	27
-	4SD10/25	1 1/4" / 1 1/2" / 2"	1226	-	1847	-	31
-	4SD10/28	1 1/4" / 1 1/2" / 2"	1340	-	1961	-	32
-	4SD10/32	1 1/4" / 1 1/2" / 2"	1492	-	2203	-	37
-	4SD10/36	1 1/4" / 1 1/2" / 2"	1644	-	2355	-	39



4SDM 10 SERIES

DEEP WELL SUBMERSIBLE PUMP

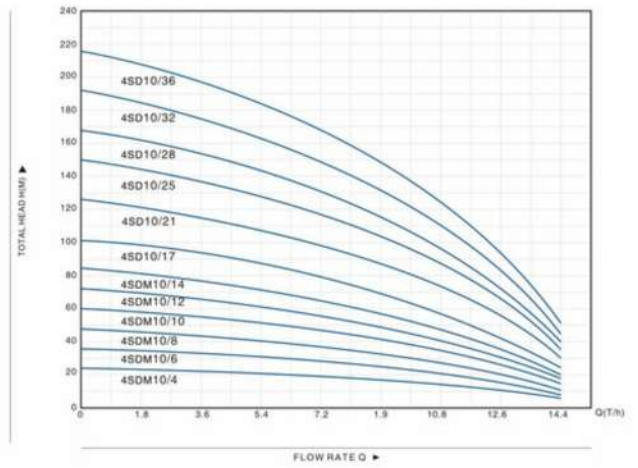

TECHNICAL DATA

Model	P2	Delivery n ~ 2850r/min												
		Q	m ³ /h L/min											
1- 220V/240V	3- 380V/415V	Kw	HP	0	1.8	3.6	5.4	7.2	9	10.8	12.6	14.4		
4SDM10/4	4SD10/4	0.55	0.75	24	23	22	20	19	16	13	10	6		
4SDM10/6	4SD10/6	0.75	1	36	34	32	30	28	24	20	15	8		
4SDM10/8	4SD10/8	1.1	1.5	48	46	43	41	37	33	27	20	11		
4SDM10/10	4SD10/10	1.5	2	60	57	54	51	47	41	34	25	14		
4SDM10/12	4SD10/12	2.2	3	72	69	65	61	56	49	40	30	17		
4SDM10/14	4SD10/14	2.2	3	84	80	76	71	65	57	47	35	20		
-	4SD10/17	3	4	102	97	92	86	79	69	57	42	24		
-	4SD10/21	4	5.5	126	120	114	107	98	86	71	52	30		
-	4SD10/25	5.5	7.5	150	143	135	127	117	102	84	62	35		
-	4SD10/28	5.5	7.5	168	160	152	142	131	114	94	70	40		
-	4SD10/32	7.5	10	192	183	173	163	149	131	108	80	45		
-	4SD10/36	7.5	10	216	206	195	183	168	147	121	90	51		

4SP SERIES

DEEP WELL SUBMERSIBLE PUMP

APPLICATIONS

- Water supply system
- Irrigation
- Garden and farm irrigation
- Lowering underground water level
- Various industrial applications

OPERATING CONDITIONS

- Dilate and clean non-corrosive liquid which does not contain solid grains or fibers
- The pump should be running under the performance range of the pump curves to prevent the motor from overheating due to lower capacity or overloading due to higher capacity

PUMP/MOTOR

- Qmax: 3 m³/h
- Adopted the NEMA standard
- Insulation class: F
- Protection grade: IP 68
- Maximum diameter: Φ35mm
- Highest temperature of liquid: 35℃

MODEL SPECIFICATION

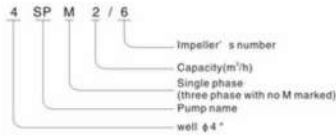

TECHNICAL DATA

Model	DN	Dimensions(mm)						Weight(kg)
		L1	L(S)	L(T)	G(S)	G(T)		
4SPM2/6	220V/240V	279	546	531	10	9		
4SPM2/9	380V/415V	342	609	594	11	10		
4SPM2/13		426	708	693	12	11		
4SPM2/18		531	833	813	15	14		
4SPM2/23		636	978	938	18	16		
4SPM2/28		741	1143	1073	22	19		
4SPM2/32		825	1227	1157	23	20		
4SPM2/40		993	1470	1385	29	25		
4SPM2/48		1161	1638	1553	31	27		
-		1308	-	1740	-	31		



4SP SERIES

DEEP WELL SUBMERSIBLE PUMP

TECHNICAL DATA

Model		P2		Delivery													
1- 220V/240V	3- 380V/415V	Kw	HP	Q	m³/h L/min	n ~2850r/min											
						0	0.3	0.6	0.9	1.2	1.5	1.8	2.1	2.4	2.7		
4SPM2/6	4SP2/7	0.37	0.5	H(m)	36	35	33	32	31	28	25	21	16	9			
4SPM2/9	4SP2/9	0.37	0.5		53	52	50	48	46	43	38	32	24	14			
4SPM2/13	4SP2/13	0.55	0.75		77	75	73	70	66	61	55	48	35	20			
4SPM2/18	4SP2/18	0.75	1		107	104	100	97	92	85	76	63	48	28			
4SPM2/23	4SP2/23	1.1	1.5		136	133	128	123	117	109	97	81	61	36			
4SPM2/28	4SP2/28	1.5	2		166	161	156	150	143	132	118	99	74	43			
4SPM2/32	4SP2/32	1.5	2		190	184	179	172	163	151	135	113	85	49			
4SPM2/40	4SP2/40	2.2	3		237	231	223	215	204	189	169	141	106	62			
4SPM2/48	4SP2/48	2.2	3		285	277	268	257	244	227	202	169	127	74			
-	4SP2/55	3	4		326	317	307	295	280	260	232	194	146	85			

TECHNICAL DATA

Model		P2		Delivery													
1- 220V/240V	3- 380V/415V	Kw	HP	Q	m³/h L/min	n ~2850r/min											
						0	1.0	2.0	3.0	4.0	5.0	6.0	7.0	8.0	9.0		
4SPM3/6	4SP3/6	0.37	0.5	H(m)	36	35	33	31	29	26	21	13					
4SPM3/9	4SP3/9	0.55	0.75		55	52	50	47	44	39	31	19					
4SPM3/12	4SP3/12	0.75	1		73	70	67	63	58	51	41	25					
4SPM3/15	4SP3/15	1.1	1.5		91	87	83	78	73	64	52	32					
4SPM3/18	4SP3/18	1.1	1.5		109	105	100	94	87	77	62	38					
4SPM3/22	4SP3/22	1.5	2		134	128	122	115	107	94	76	47					
4SPM3/25	4SP3/25	1.5	2		150	146	139	131	121	107	86	53					
4SPM3/32	4SP3/32	2.2	3		194	186	178	167	155	137	110	68					
-	4SP3/40	3	3		243	233	222	209	194	172	138	85					
-	4SP3/52	4	4		316	303	289	272	252	223	179	110					

TECHNICAL DATA

Model		P2		Delivery																			
1- 220V/240V	3- 380V/415V	Kw	HP	Q	m³/h L/min	n ~2850r/min																	
						0	0.6	1.2	1.8	2.4	3	3.6	4.2	4.8	5.4	6	6.6						
4SPM5/4	4SP5/4	0.37	0.5	H(m)	25	24	23	22	21	20	18	17	15	12	9								
4SPM5/6	4SP5/6	0.55	0.75		37	36	35	33	32	31	29	28	25	22	18	13							
4SPM5/8	4SP5/8	0.75	1		50	48	46	44	43	41	39	37	34	29	23	17							
4SPM5/12	4SP5/12	1.1	1.5		75	72	69	67	64	62	59	55	50	44	35	26							
4SPM5/17	4SP5/17	1.5	2		106	102	98	94	91	87	83	78	71	62	50	36							
4SPM5/24	4SP5/24	2.2	3		150	144	138	133	128	123	118	110	101	87	70	51							
-	4SP5/32	3	4		200	192	184	178	171	165	157	147	134	118	94	68							
-	4SP5/38	4	5.5		237	228	219	211	203	195	186	174	159	138	111	81							
-	4SP5/42	4	5.5		262	252	242	233	224	216	206	193	176	153	123	90							
-	4SP5/52	5.5	7.5		325	312	299	289	278	267	255	239	218	189	152	111							
-	4SP5/58	5.5	7.5		362	348	334	322	310	298	284	266	243	211	170	124							

TECHNICAL DATA

Model		P2		Delivery													
1- 220V/240V	3- 380V/415V	Kw	HP	Q	m³/h L/min	n ~2850r/min											
						0	1.2	2.4	3.6	4.8	6	7.2	8.4	9.6	10.8		
4SPM8/5	4SP8/5	0.75	1	H(m)	29	28	27	25	24	22	21	19	15	10			
4SPM8/7	4SP8/7	1.1	1.5		41	39	37	35	33	31	29	26	21	15			
4SPM8/10	4SP8/10	1.5	2		59	56	53	50	47	45	41	37	30	21			
4SPM8/12	4SP8/12	2.2	3		70	67	64	60	57	54	50	44	36	25			
4SPM8/14	4SP8/14	2.2	3		82	78	75	70	66	63	58	52	42	29			
-	4SP8/18	3	4		105	101	96	91	85	80	75	67	55	38			
-	4SP8/22	4	5.5		129	123	117	111	104	96	91	82	67	46			
-	4SP8/25	4	5.5		146	140	133	126	118	112	104	93	76	52			
-	4SP8/30	5.5	7.5		176	168	160	151	142	134	124	111	91	63			
-	4SP8/34	5.5	7.5		199	190	181	171	161	152	141	126	103	71			

4SKM SERIES

DEEP WELL SUBMERSIBLE PUMP

APPLICATIONS

- For 4" wells.
- Pumping clean water in to Detached houses, Country houses and farms, Cottages.
- Moving water in fountains.
- Rain intakes.
- Feeding pressure systems.
- Filling and emptying tanks.

OPERATING CONDITIONS

- Qmin: 2.9 l/min
- Capacity from 0.5 to 1.5 m³/h
- Totalhead from 84 to 140 m
- Highest temperature of liquid: 20°C

MOTOR

- Insulation class B
- Protection grade IP X3

STRUCTURE

- Shaft, Jacker and hydraulics in stainless steel
- Brass impeller
- Built-in non-return valve
- Thermoplastic parts
- Oil-cooled motor with compensating diaphragm
- Graphite mechanical seal protected by sand-pro ring
- 4SKm 100 parts are non-toxic and non-polluting
- Thanks to special construction features, both installation and maintenance of 4SKm 100 are fast and easy



MODEL SPECIFICATION

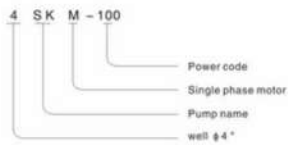

4SKM SERIES

DEEP WELL SUBMERSIBLE PUMP

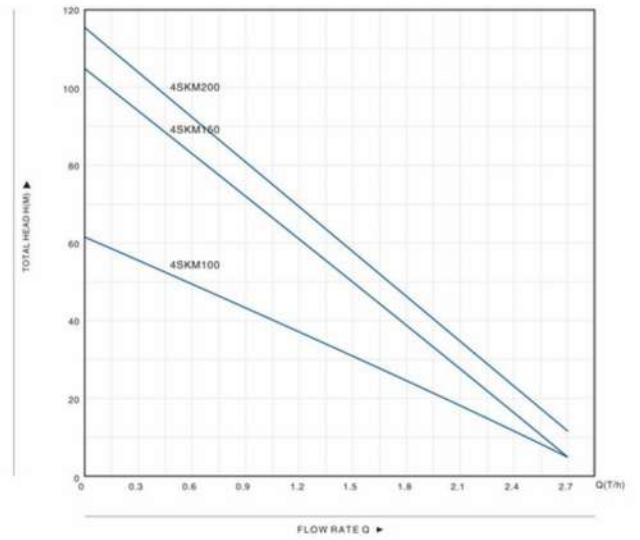

TECHNICAL DATA

Model	P2	Delivery										n ~2850r/min					
		1-220V/240V	3-380V/415V	Kw	HP	Q	m³/h	0	0.3	0.6	0.9		1.2	1.5	1.8	2.1	2.4
4SKM100	4SK100	0.75	1			62	56	49	43	37	30	24	18	11	5		
4SKM150	4SK150	1.1	1.5	H(m)		105	94	83	72	61	49	38	27	16	5		
4SKM200	4SK200	1.5	2			115	104	92	81	69	58	46	35	24	12		

3QG/4QG SERIES

DEEP WELL SUBMERSIBLE PUMP

APPLICATIONS

- For water supply from wells or reservoirs.
- For domestic use for civil and industrial applications.
- For garden use and irrigation.

OPERATING CONDITIONS

- Maximum fluid temperature up to +42°
- Maximum sand content 2%
- Maximum injection 15m
- 3QG minimum well diameter 3"
- 4QG minimum well diameter 4"

MOTOR AND PUMP

- Thermobal motor
- Three phase 380V-415V-50Hz
- Single phase 220V-240V-50Hz

OPTIONS ON REQUEST

- Special mechanical seal
- Other voltages or frequency 60HZ

MODEL SPECIFICATION

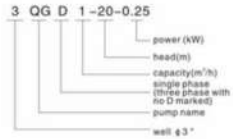

Components	Material
Delivery casing	AISI 304 SS
Strainer	AISI 304 SS
Motor external casing	AISI 304 SS
Top check	Cast-iron ASTM N0.30
Bottom support	AISI 304 SS
Mechanical seal	Graphite-Ceramic/TC
Shell	AISI 303 SS-ASTM 1045

3QG/4QG SERIES

DEEP WELL SUBMERSIBLE PUMP

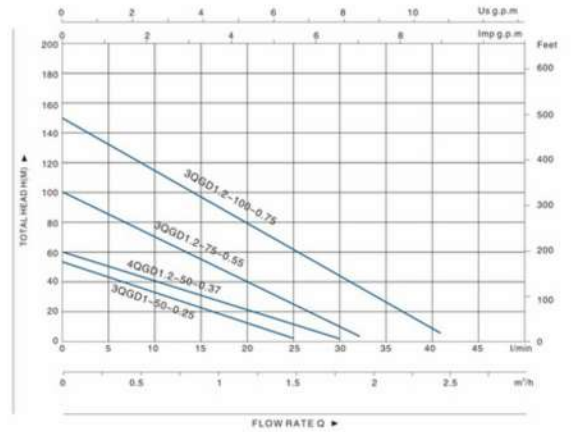

TECHNICAL DATA

Model	P2		Capacity (m ³ /h)	Head (m)	Outlet (inch)	Speed (l/min)	Dimensions (mm)		
	1-220V/240V	3-380V/415V					φ D	L	
3QG D1.5-60-0.25	-	-	1.0	50	1"	2850	74	520	
3QG D1.2-50-0.37	-	-	1.2	50	1"	2850	74	560	
3QG D1.2-75-0.55	-	-	1.2	75	1"	2850	74	600	
3QG D1.2-100-0.75	-	-	1.2	100	1"	2850	74	645	
4QG D1.2-50-0.37	-	-	1.2	50	1"	2850	96	540	
4QG D1.5-60-0.55	-	-	1.5	60	1"	2850	96	580	
4QG D1.25-100-0.75	4QG D1.2-100-0.75	0.75	1	1.2	100	1"	2850	96	620
4QG D1.5-120-1.1	4QG D1.5-120-1.1	0.75	1.5	1.5	75	1"	2850	96	600

STRUCTURE DIAGRAM OF CIRCULATION PUMP

CHARACTERISTICS

■ The water pump structure adopts stainless steel sleeve to completely separate the iron core inside of engine from water and it desalts the traditional mechanical seal structure so that the conventional water leakage problem has been thoroughly resolved; the structure adopts ceramic bearing and ceramic or stainless steel spindle, which is wear-resisting, corrosion-resisting, and lubricated by water naturally with less noise; the total pump head operating voltage will not be overloaded and if it is applied appropriately, the service life should be long; high-temperature choice materials are adopted for all components inside of engine, which is applicable for hot-water circulation pressurization system; the pump can be equipped with water control automatic switch, which is convenient for usage; the pump line box is designed with three-position speed adjustment switch so that the user can regulate speed in accordance with different environments and requirements.



STRUCTURE DIAGRAM OF CIRCULATION PUMP

PRODUCT USE

■ The pump is applicable for cold-hot water circulation and pressurization; particularly, the shower set might lead to fire because of low or unstable water pressure and installation & application of this pump can easily totally solve the problem; in addition, it is also applicable for pressurization water supply of the household low water pressure, water supply of solar water heater, hot-water circulation of boiler, and circulation pressurization of air conditioner & refrigerating system.

WORKING CONDITIONS

- Pumped medium temperature scope: 0°C ~ +90°C
 - Maximum application environment temperature: +40°C
 - Medium requirement: clean without sundries, mineral oil, stickiness, and corrosiveness;
 - Chemical property: the property is closed to neutral without explosiveness and it is like liquid of water (the content of ethylene glycol is up to 30%.)
 - It is necessary to consult the manufacturer first if other liquids are extracted
 - Maximum operating pressure: 5 bar
- Minimum inlet pressure:
 When the temperature is +50°C: 0.05bar
 When the temperature is +70°C: 0.3bar
 When the temperature is +90°C: 1.0bar
 The above-mentioned values are only applicable for elevation of 300m; as for the higher elevation, 0.01bar should be added for every 100m increased. To prevent noise generated by cavitation erosion, the minimum inlet pressure should be maintained.
- The pump should be operated between ~ 10% of the rating voltage; if the voltage is too low, the pump will be overloaded, which will lead to temperature increase of engine and decrease of pump head & pressure curve.

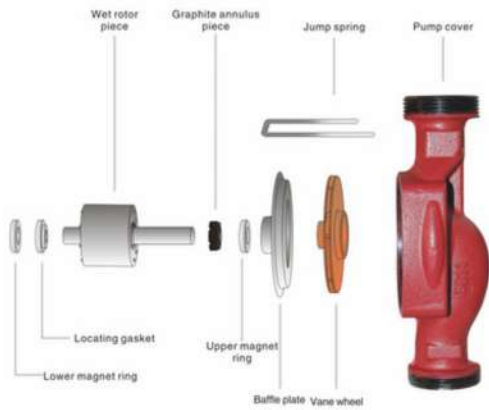

CIRCULATION

PUMP



DPS15-8.5Z



DPA15-8.5Z



DPS20-13Z



DPS20-4S



DPS25-4S



DPS32-4S

TECHNICAL DATA

Model	Power (w)	Q. Max (L/min)	H. Max (m)	Pipe size (inch)	Pump body length (mm)	Vol./Fre. (V/Hz)	N.W. (kg)	Packing dimension		20GP (pcs)
								(mm)	pcs/ctn	
DPA15-8.5Z	100	30	8.5	3/4"	160	220/50	2.5	365 x 295 x 310	8	7000
DPS15-8.5Z	100	30	8.5	3/4"	160	220/50	2.5	345 x 295 x 315	8	7200
DPS20-13Z	245	50	13	1"	180	220/50	4.2	410 x 340 x 210	4	4000

CIRCULATION

PUMP

TECHNICAL DATA

Model	Power (w)	Q. Max (L/min)	H. Max (m)	Inlet/Outlet (inch)	Pump body length (mm)	N.W. (kg)	Packing dimension		20GP (pcs)
							(mm)	pcs/ctn	
DPS20-4S	72/53/38	42	4	1"	130	2.2	340 x 295 x 325	8	7200
DPS25-4S	72/53/38	48	4	1 1/2"	180/130	2.3	405 x 270 x 300	8	7080
DPS32-4S	72/53/38	48	4	2"	180	2.4	405 x 270 x 300	8	7080

CIRCULATION

PUMP



TECHNICAL DATA

Model	Power (w)	Q. Max (L/min)	H. Max (m)	Inlet/Outlet (inch)	Pump body length (mm)	N.W. (kg)	Packing dimension		20GP (pcs)
							(mm)	pcs/ctn	
DPS20-6S	93/67/46	48	6	1"	130	2.2	340 x 295 x 325	8	7200
DPS25-6S	93/67/46	53	6	1 1/2"	180/130	2.5	405 x 270 x 300	8	7080
DPS32-6S	93/67/46	53	6	2"	180	2.6	405 x 270 x 300	8	7080

67 PAGINATION / ENTERPRISE

CIRCULATION

PUMP



TECHNICAL DATA

Model	Power (w)	Q. Max (L/min)	H. Max (m)	Inlet/Outlet (inch)	Pump body length (mm)	N.W. (kg)	Packing dimension		20GP (pcs)
							(mm)	pcs/ctn	
DPS25-8S	260/210/140	90	8	1 1/2"	180	4.3	430 x 290 x 220	4	4200
DPS32-8S	260/210/140	105	8	2"	180	4.3	430 x 290 x 220	4	4200

PAGINATION / ENTERPRISE 68

VMP

MASKING VIBRATION PUMPS



VMP60



VMP60-1

WORKING GONDMON

- For clear water, PH: 6.5-8.5
- Solid impurity no more than 0.1%
- Fluid temperature: 0-40°C
- Maximum ambient temperature: -40°C

MOTOR

- Degree of protection: IP68
- Insulation class: F
- Continuous operation

PERFORMANCE CHART AT $n = 2850 \text{ min}^{-1}$

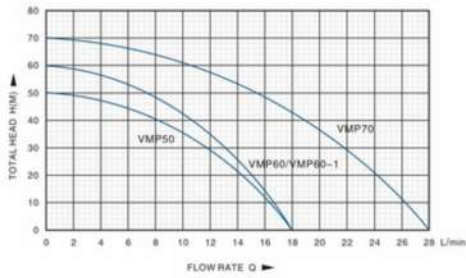

TECHNICAL DATA

Model	Power (w)	Q.Max. (L/min)	H.Max. (m)	Max.Depth (m)	Outlet	Packing dimension (mm)
VMP50	180	18	50	5	1/2"	295 × 115 × 145
VMP60	280	18	60	5	1/2"	295 × 115 × 155
VMP60-1	280	18	60	5	1/2"	295 × 115 × 155
VMP70	370	28	70	5	1/2"	320 × 120 × 155

ACCESSORIES



PC-10



PC-12



PC-13

Model	PC-10
Rated Voltage	110-120V/220-240V
Power frequency	50/60HZ
Max Power	1.1kW
Starting Pressure Setting	1.2 bar, 1.5 bar, 2.2 bar
Max Working Pressure	10 bar
Connection Thread	G1", NPT1"
Protection Rating	IP65
Max Working Temperature	60°C
BOX SIZE	230 × 166 × 177 MM
CARTON SIZE	520 × 470 × 370 MM
PCS/CTN	12 PCS/CTN
N.W/G.W	13/16.2KGS
20GP	3840 PCS

Model	PC-12
Rated Voltage	110-120V/220-240V
Power frequency	50/60HZ
Max Power	1.1kW
Starting Pressure Setting	1.2 bar, 1.5 bar, 2.2 bar
Max Working Pressure	10 bar
Connection Thread	G1", NPT1"
Protection Rating	IP65
Max Working Temperature	60°C
BOX SIZE	255 × 143 × 125 MM
CARTON SIZE	530 × 450 × 270 MM
PCS/CTN	12 PCS/CTN
N.W/G.W	12/16.2KGS
20GP	5400 PCS

Model	PC-13
Rated Voltage	110-120V/220-240V
Power frequency	50/60HZ
Max Power	1.1kW
Starting Pressure Setting	1.2 bar, 1.5 bar, 2.2 bar
Max Working Pressure	10 bar
Connection Thread	G1", NPT1"
Protection Rating	IP65
Max Working Temperature	60°C
BOX SIZE	155 × 133 × 230 MM
CARTON SIZE	475 × 420 × 330 MM
PCS/CTN	12 PCS/CTN
N.W/G.W	13.2/16.5KGS
20GP	5280 PCS

ACCESSORIES



PC-13A

Model	PC-13A
Rated Voltage	110-120V/220-240V
Power frequency	50/60HZ
Max Power	1.1kW
Starting Pressure Setting	1.2 bar, 1.5 bar, 2.2 bar
Max Working Pressure	10 bar
Connection Thread	G1" , NPT1"
Protection Rating	IP65
Max Working Temperature	60°C
BOX SIZE	155 x 133 x 230 MM
CARTON SIZE	475 x 420 x 330 MM
PCS/CTN	12 PCS/CTN
N.W/G.W	13.2/16.5KGS
20GP	5280 PCS



PC-13B

Model	PC-13B
Rated Voltage	110-120V/220-240V
Power frequency	50/60HZ
Max Power	1.1kW
Starting Pressure Setting	1.2 bar, 1.5 bar, 2.2 bar
Max Working Pressure	10 bar
Connection Thread	G1" , NPT1"
Protection Rating	IP65
Max Working Temperature	60°C
BOX SIZE	186 x 133 x 230 MM
CARTON SIZE	415 x 385 x 480 MM
PCS/CTN	12 PCS/CTN
N.W/G.W	15.6/17.6KGS
20GP	4560 PCS



PC-13C

Model	PC-13C
Rated Voltage	110-120V/220-240V
Power frequency	50/60HZ
Max Power	1.1kW
Starting Pressure Setting	1.2 bar, 1.5 bar, 2.2 bar
Max Working Pressure	10 bar
Connection Thread	G1" , NPT1"
Protection Rating	IP65
Max Working Temperature	60°C
BOX SIZE	155 x 133 x 230 MM
CARTON SIZE	475 x 420 x 330 MM
PCS/CTN	12 PCS/CTN
N.W/G.W	13.2/16.5KGS
20GP	5280 PCS

ACCESSORIES



PC-15

Model	PC-15
Rated Voltage	110-120V/220-240V
Power frequency	50/60HZ
Max Power	1.1kW
Starting Pressure Setting	1.2 bar, 1.5 bar, 2.2 bar
Max Working Pressure	10 bar
Connection Thread	G1" , NPT1"
Protection Rating	IP65
Max Working Temperature	60°C
BOX SIZE	202 x 103 x 103 MM
CARTON SIZE	420 x 325 x 215 MM
PCS/CTN	12 PCS/CTN
N.W/G.W	6.5/8KGS
20GP	11880 PCS



PC-19

Model	PC-19
Rated Voltage	110-120V/220-240V
Power frequency	50/60HZ
Max Power	1.1kW
Starting Pressure Setting	1.2 bar, 1.5 bar, 2.2 bar
Max Working Pressure	10 bar
Connection Thread	G1" , NPT1"
Protection Rating	IP65
Max Working Temperature	60°C
BOX SIZE	150 x 150 x 180 MM
CARTON SIZE	460 x 310 x 385 MM
PCS/CTN	12 PCS/CTN
N.W/G.W	12.5/14.5KGS
20GP	6360 PCS



PC-19B

Model	PC-19B
Rated Voltage	110-120V/220-240V
Power frequency	50/60HZ
Max Power	1.1kW
Starting Pressure Setting	1.2 bar, 1.5 bar, 2.2 bar
Max Working Pressure	10 bar
Connection Thread	G1" , NPT1"
Protection Rating	IP65
Max Working Temperature	60°C
BOX SIZE	160 x 150 x 190 MM
CARTON SIZE	460 x 320 x 445 MM
PCS/CTN	12 PCS/CTN
N.W/G.W	14.64/15.8KGS
20GP	5304 PCS

SPA6-28 2-1.1F

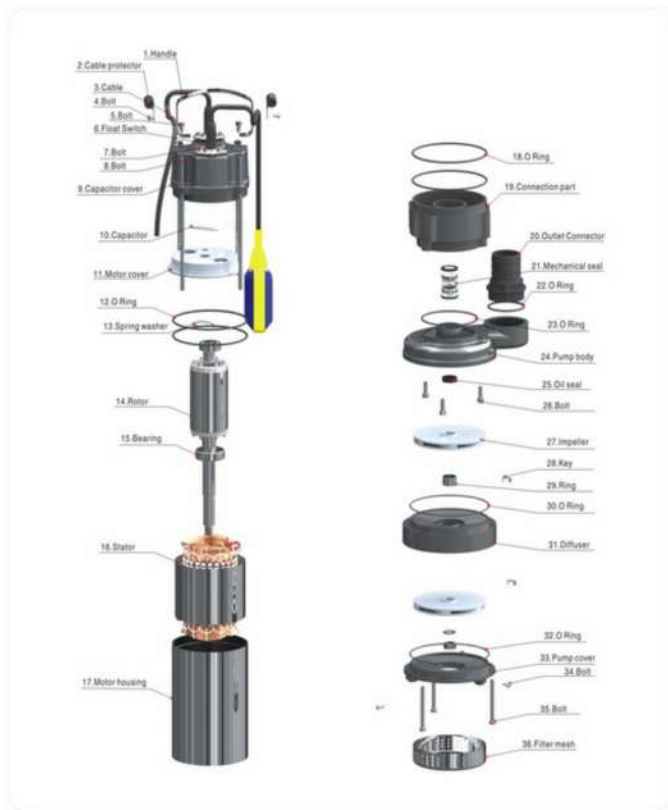

V370F



V750F

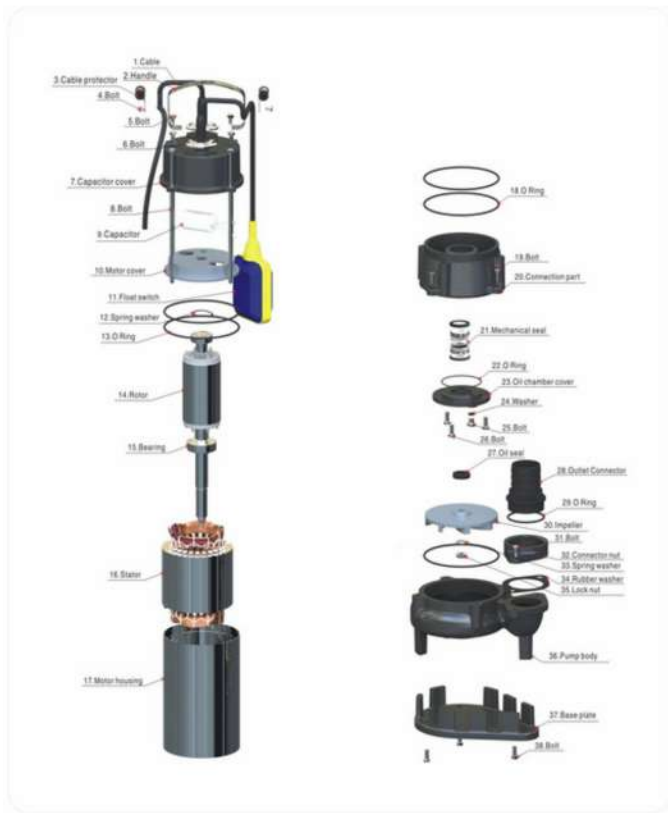

V1100DF



V1100F



V2200F



WQD



DMC



POUR TOUTES NOS
POMPES ET UTILISATIONS



**Appelez nous pour trouver
la pompe dont vous avez
besoin !**



09 70 44 02 48

